

PLANT LEGEND

TREES	CODE	BOTANICAL / COMMON NAME	DESCRIPTION
	CB	Carphium bracteatum / Brazier Beautyflax	3 Gal., 18" H. x 18" Spr. Min., Full and Dense, Full to Base
	CD	Coccoloba diversifolia / Pigeon Plum	Container Grown, 10" H. x 4" Spr., Full Canopy
	CE	Conocarpus erectus / Green Button Wood	8.6 B. 12" H. x 5" Spr., 2.5" Cal., Single Straight Trunk, Full Canopy
	CE2	Conocarpus erectus / Silver Button Wood	8.6 B. 12" H. x 5" Spr., 2.5" Cal., Single Straight Trunk, Full Canopy
	CE3	Conocarpus erectus / Silver Button Wood	8.6 B. 12" H. x 5" Spr., 2.5" Cal., Single Straight Trunk, Full Canopy
	CS	Cordia sebestena / Orange Tree Trunk	Container Grown, 12" H. x 6" Spr., 2" Cal., Single Trunk, Full Canopy
	DR	Davallia regia / Royal Polka Dot	Container Grown, 12" H. x 5" Spr., 2.5" Cal., Single Trunk, Full Canopy
	E	Elaeagnus / East Palmetto	45 Gal., 12" H. x 5" Spr. Min., 2.5" Cal. Min., 3" CT Min., Single Straight Trunk, Full Canopy, To be Pruned and Maintained in a Natural Shape and Form
	LM	Ligustrum japonicum / Japanese Privet	Container Grown, 12" H. x 5" Spr., Full and Dense Crown
	LJ	Ligustrum japonicum / Japanese Privet	Container Grown, 6" H. x 5" Spr., Full and Dense Crown
	MG	Magnolia grandiflora / D.D. Blandford	11" Southern Magnolia Container Grown, 12" H. x 5" Spr., 3" CT, Straight Trunks, Full Dense Canopy
	QV	Quercus virginiana / Southern Live Oak	Field Grown, 12" H. x 5" Spr., 2.5" Cal., Straight Trunk, Full Canopy
	QV-18	Quercus virginiana / Southern Live Oak	18" H. x 5" Spr., 4" Cal., Single Straight Trunk, Full and Even Canopy
	TH	Tabebuia heterophylla / Pink Tabebuia	Container Grown, 12" H. x 5" Spr., 2.5" Cal., Single Straight Trunk, Full Canopy
PALM TREES	CODE	BOTANICAL / COMMON NAME	DESCRIPTION
	CN	Coccothrinax / Green Malay Palm	Field Grown, Varying Heights, 8-12" GW, Full Head, No Scarced Trunk
	RD	Rhapis excelsa / Medjool / Date Palm	Field Grown, 20" CT, Florida Fancy, Classic cut, Matched Hbs., Full Crown
	PE10	Phytolacca elegans / Alexander Palm	Field Grown, Varying Heights, 12-18" CT, Slit Straight Trunk, No Scars, Full Crown
	RD	Rhapis excelsa / Florida Royal Palm	Field Grown, 14" CT, 17" CT, 22" CA H., 24" Cal. Heavy Straight Trunk, No Scars, Full Crown
	SP	Sabal palmetto / Cabbage Palmetto	Field Grown, Varying Heights, 12-18" CT, Slit Straight Trunk, Hurricane Cut
	SPB	Sabal palmetto / Curved Trunk Sabal Palm	Field Grown, Varying Heights, 15-20" CT, Slit Trunk, Curved, Hurricane Cut
LITTORAL TREES	CODE	BOTANICAL / COMMON NAME	DESCRIPTION
	AR-L	Acrocydium / Red Maple	Container Grown, 14" DA H. Min. x 4-6" Spr. Min., Straight Trunk, Full Canopy
	AR-M	Acrocydium / Red Maple	Container Grown, 10" DA H. Min. x 3-4" Spr. Min., Straight Trunk, Full Canopy
	AR-S	Acrocydium / Red Maple	Container Grown, 10" DA H. Min. x 3-4" Spr. Min., Straight Trunk, Full Canopy
	TD-L	Taxodium distichum / Bald Cypress	Container Grown, 14" DA H. Min. x 5-6" Spr. Min., Straight Trunk, Even Canopy, Full
	TD-M	Taxodium distichum / Bald Cypress	Container Grown, 12" DA H. Min. x 4-6" Spr. Min., Straight Trunk, Even Canopy, Full
	TD-S	Taxodium distichum / Bald Cypress	Container Grown, 10" DA H. Min. x 3-4" Spr. Min., Straight Trunk, Even Canopy, Full
SHRUBS	CODE	BOTANICAL / COMMON NAME	DESCRIPTION
	CHR	Chrysanthemum / Ribbon Fringe Chrysanthemum	3 Gal., 18" H. x 12" Spr., 30" O.C., Full to Base and Dense
	CLU	Clusia guttata / Small-Leaf Clusia	3 Gal., 18" H. x 18" Spr., 30" O.C., Full and Dense
	CRI	Citrus aurantium / Queen Emma / Queen Emma Citrus	1 Gal., 18" H. x 18" Spr., 30" O.C., Disease Free, Spacious
	PMA	Podocarpus macrophyllus / Yew Pine	7 Gal., 48" H. x 24" Spr., Full to Base and Dense
	SRE	Serenoa repens / Saw Palmetto	3 Gal., 18" H. x 18" Spr. Min., Full and Dense, Full to Base
	BTR	Bursera simaruba / Bird Of Paradise	7 Gal., 30" H. x 24" Spr., 2-3 PPP, Full and Dense
SHRUB AREAS	CODE	BOTANICAL / COMMON NAME	DESCRIPTION
	ASP	Aspidistra / White African Iris	3 Gal., 18" H. x 18" Spr., 30" O.C., Fully Rooted and Dense
	DE	Delonix regia / White African Iris	3 Gal., 18" H. x 18" Spr., 30" O.C., Fully Rooted and Dense
	FIC	Ficus microcarpa / Green Island / Green Island Ficus	3 Gal., 12" H. x 10" Spr., 24" O.C., Fully Rooted and Dense
	HAM	Hamelia patens / Fire Bush	1 Gal., 12" H. x 10" Spr., 40" O.C., Full and Dense
	HO	Hoya / Hoya Grant / Hoya	3 Gal., 18" H. x 18" Spr., 24" O.C., Full to Base, Dense, Red
	JAS	Jasminum visibille / Wax Jasmine	3 Gal., 12" H. x 12" Spr., 30" O.C., Full and Dense, Full to Base

SHEET KEY

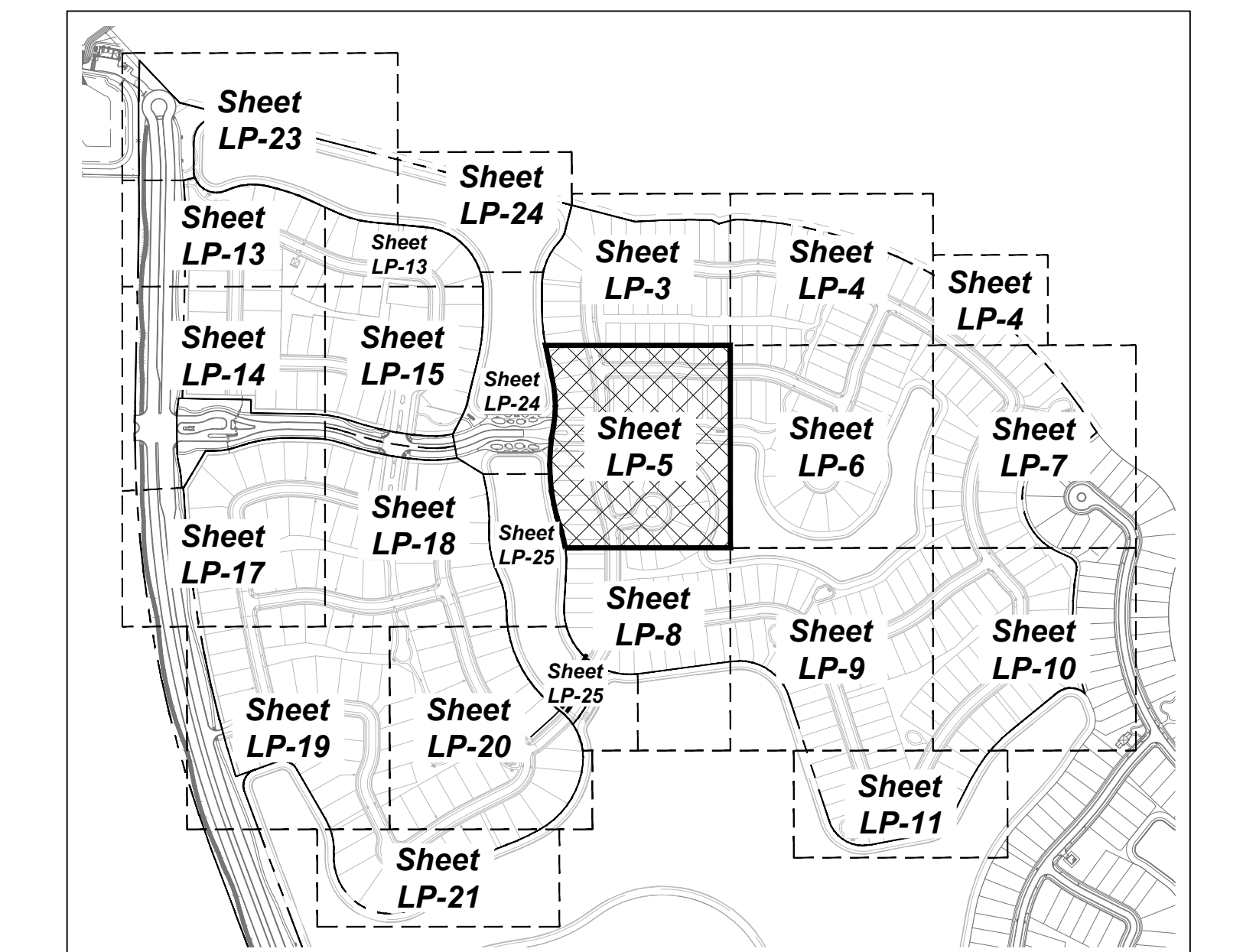

Urban design kilday STUDIOS

Urban Planning & Design
Landscape Architecture
Communication Graphics

610 West Palm Street, Suite CU02
West Palm Beach, FL 33401
561.366.1100 FAX 561.366.1111
www.udkstudios.com
HLC0000035

Copyright:
All ideas, designs, arrangements, and plans represented by this drawing are owned by and the property of the designer, and were created for the exclusive use of the specified project. These ideas, designs, arrangements or plans shall not be used by, or disclosed to, any person, firm, or corporation without the written permission of the designer.

Avenir - Site Plan #3
A Planned Community Development
Palm Beach Gardens, Florida
Landscape Plans - Pod 6

LP-5
of 36

Scale: 1" = 30'-0"

Date: February 2019
Project No.: 12-065.003
Designed By: TP
Drawn By: WV/JB/BB
Checked By: KT

Revision Dates:

- 02/13/19 PBG Submittal
- 05/24/19 PBG Resubmittal
- 08/16/19 PBG Resubmittal
- 09/20/19 PBG Resubmittal
- 10/31/19 PBG Resubmittal
- 02/21/20 PBG Resubmittal
- 04/08/20 PBG Resubmittal
- 04/27/20 PBG Resubmittal

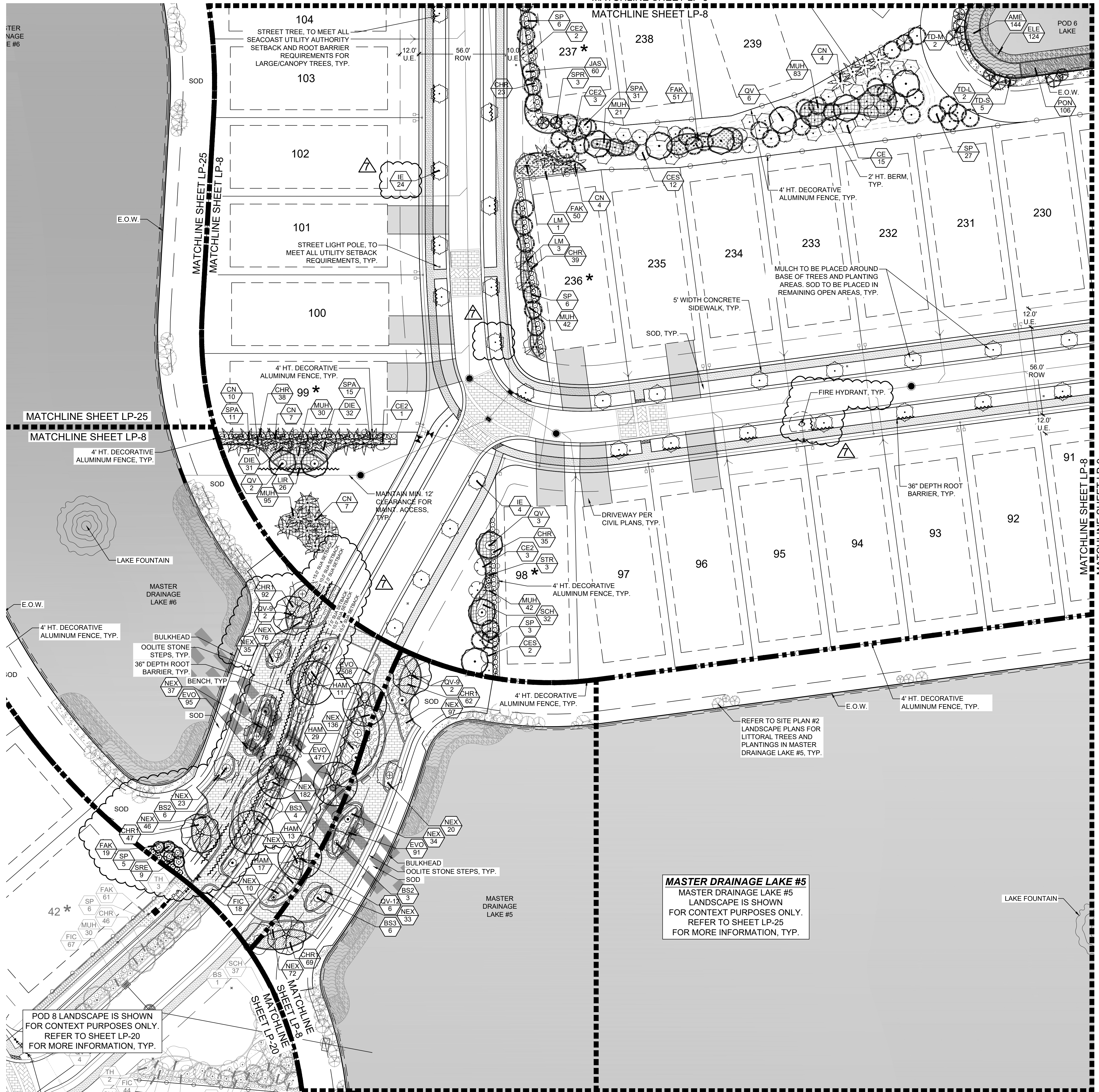

PLANT LEGEND

TREES	CODE	BOTANICAL / COMMON NAME	DESCRIPTION		
TREES	CB	Casipoum brasiliense / Brazilian Beautyleaf	3 Gal., 18" H. x 18" Spr. Min., Full and Dense, Full to Base		
	CD	Coccoloba diversifolia / Pigean Plum	Container Grown, 10" H. x 4" Spr., Full Canopy		
	CE	Conocarpus erectus / Green Button Wood	8.8 B. 12" H. x 5" Spr., 2.5" Cal., Single Straight Trunk, Full Canopy		
	CE2	Conocarpus erectus setosus / Silver Button Wood	8.8 B. 12" H. x 5" Spr., 2.5" Cal., Single Straight Trunk, Full Canopy		
	CE3	Conocarpus erectus setosus / Silver Button Wood	Multi Trunk 8.8 B. 12" H. x 5" Spr., 2.5" Cal., Single Straight Trunk, Full Canopy		
	CS	Cordia sebestena / Orange Tree Trunk	Container Grown, 12" H. x 6" Spr., 2" Cal., Single Trunk, Full Canopy		
	DR	Drymonia regia / Royal Poinciana	Container Grown, 12" H. x 5" Spr., 2.5" Cal., Single Trunk, Full Canopy		
	E	Elaeagnus multiflora / East Palmetto Holly	45 Gal., 12" H. x 5" Spr. Min., 2.5" Cal. Min., 3" CT Min., Single Straight Trunk, Full Canopy, To be Pruned and Maintained in a Natural Shape and Form		
	LM	Ligustrum japonicum / Japanese Privet	Container Grown, 12" H. x 5" Spr. Min., 3" CT Min., Single Straight Trunk, 2.5" Cal., Multi-Trunk, Wide Canopy, Lavender Blooms		
	LJ	Ligustrum japonicum / Japanese Privet	Container Grown, 6" H. x 5" Spr., Full and Dense Crown		
	MG	Magnolia grandiflora / D.D. Blandford / Southern Magnolia	Container Grown, 12" H. x 5" Spr., 3" CT, Straight Trunks, Full Dense Canopy		
	OV	Quercus virginiana / Southern Live Oak	Container Grown, 12" H. x 5" Spr., 2.5" Cal., Single Straight Trunk, Full Canopy		
	OV-18	Quercus virginiana / Southern Live Oak	18" H. x 5" Spr., 4" Cal., Single Straight Trunk, Full and Even Canopy, No Low Growth		
	TH	Tabebuia heterophylla / Pink Tabebuia	Trunk, Full Canopy		
	PALM TREES	CN	Coccothrinax / Green Malayan / Coconut Palm	Field Grown, Varying Heights, 8-12' GW, Full Head, No Scarred Trunk	
RD		Phoenix dactylopera / Medjool / Date Palm	Field Grown, 20' CT, Florida Fancy, Classic out, Matched Hts., Full Crown		
PE10		Phycosperma elegans / Alexander Palm	Field Grown, Trips, Minimum 10' CW		
RD		Royalstonia elata / Florida Royal Palm	Field Grown, 14' CW, 17' CT, 22' GA Ht., 24" Cal. Heavy Straight Trunk, No Scar, Full Crown		
SP		Sabal palmetto / Cabbage Palmetto	Field Grown, Varying Heights, 12-18' CT, Slit Straight Trunk, Hurricane Cut		
SPB		Sabal palmetto / Curved Trunk Sabal Palm	Field Grown, Varying Heights, 15-20' CT, Slit Trunk, Curved, Hurricane Cut		
LITTORAL TREES		AKL	Acrocarpus / Red Maple	Container Grown, 14" DA Ht. Min. x 5-6" Spr. Min., Straight Trunk, Full Canopy	
		ARM	Acrocarpus / Red Maple	Container Grown, 12" DA Ht. Min. x 4-5" Spr. Min., Straight Trunk, Full Canopy	
		ARS	Acrocarpus / Red Maple	Container Grown, 10" DA Ht. Min. x 3-4" Spr. Min., Straight Trunk, Full Canopy	
		TD-L	Taxodium distichum / Bald Cypress	Container Grown, 14" DA Ht. Min. x 5-6" Spr. Min., Straight Trunk, Even Canopy, Full	
		TD-M	Taxodium distichum / Bald Cypress	Container Grown, 14" DA Ht. Min. x 5-6" Spr. Min., Straight Trunk, Even Canopy, Full	
		TD-S	Taxodium distichum / Bald Cypress	Container Grown, 10" DA Ht. Min. x 3-4" Spr. Min., Straight Trunk, Even Canopy, Full	
		SHRUBS	CHR	Chrysothamnus / Red Fireweed / Fireweed	3 Gal., 18" H. x 12" Spr., 30" O.C., Full to Base and Dense
			CLU	Clusia guttata / Small-Leaf Clusia	3 Gal., 18" H. x 18" Spr., 30" O.C., Full and Dense
			CRI	Croton aureum / Queen Emma / Queen Emma / Citrum	1 Gal., 1 P.P.P. 3" H. x 3" Spr., Disease Free, Spacious
	PMA		Podocarpus macrophyllus / Yew Pine	7 Gal., 48" H. x 24" Spr., Full to Base and Dense	
	SRE		Senecio repens / Saw Palmetto	3 Gal., 18" H. x 18" Spr. Min., Full and Dense, Full to Base	
	BTR		Strelitzia reginae / Bird of Paradise	7 Gal., 30" H. x 24" Spr., 2-3 P.P.P., Full and Dense	
	SHRUB AREAS		ASP	Asplenium platyneuron / Fern	3 Gal., 14" H. x 14" Spr., 24" O.C.
			DE	Delonix elata / White African Iris	3 Gal., 18" H. x 18" Spr., 30" O.C., Fully Rooted and Dense
			FIC	Ficus microcarpa / Green Island Ficus	3 Gal., 12" H. x 18" Spr., 24" O.C., Fully Rooted and Dense
HAM			Hamelia patens / Fire Bush	1 Gal., 12" H. x 18" Spr., 48" O.C., Full and Dense	
HO			Hoya / Hoya	3 Gal., 18" H. x 18" Spr., 24" O.C., Full to Base, Dense, Red	
JAS			Jasminum volatile / Wax Jasmine	3 Gal., 12" H. x 12" Spr., 30" O.C., Full and Dense, Full to Base	

SHEET KEY

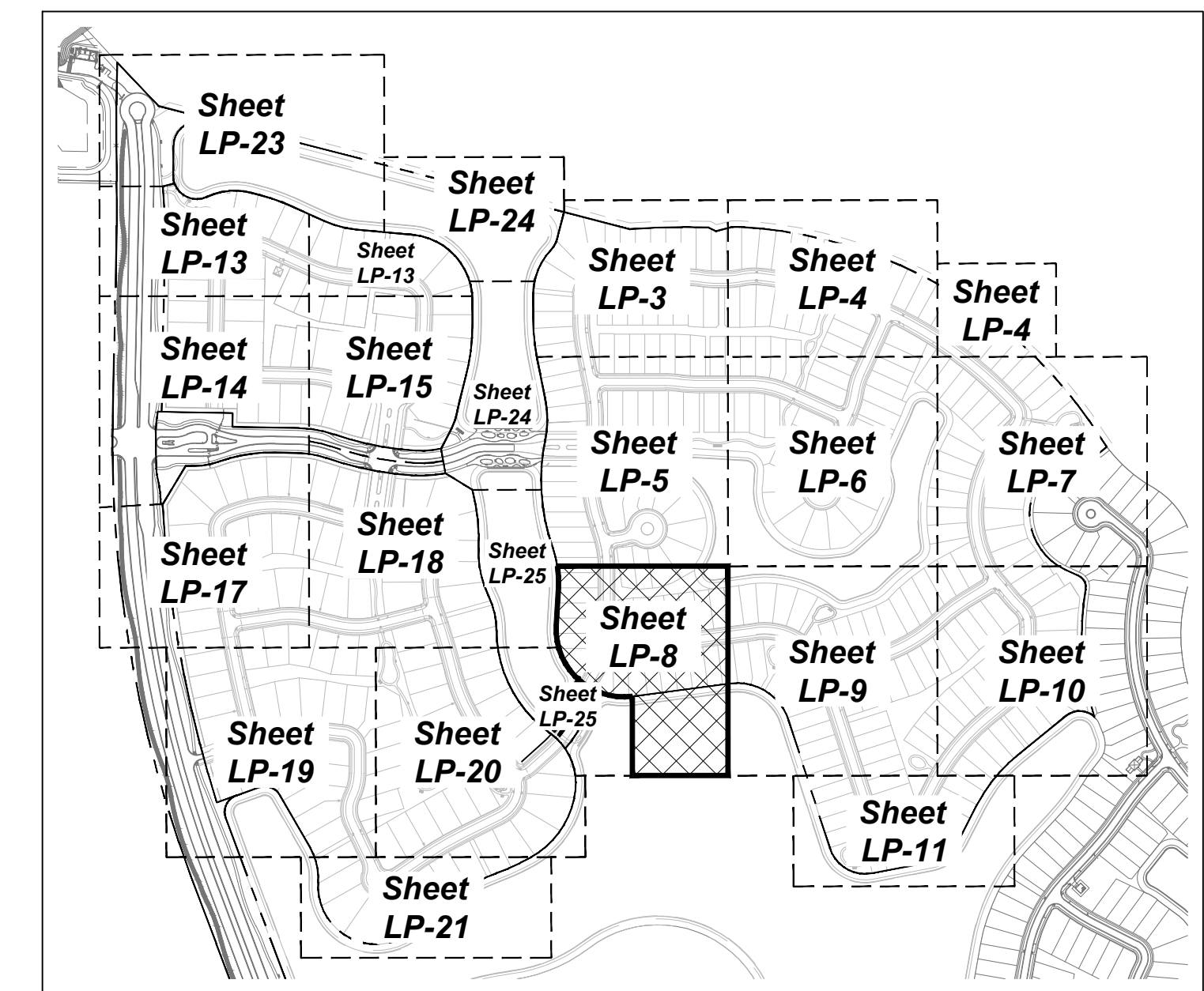

Urban design kilday STUDIOS
 Urban Planning & Design
 Landscape Architecture
 Communication Graphics
 610 Clematis Street, Suite CU02
 West Palm Beach, FL 33401
 561.366.1100 FAX 561.366.1111
 www.udkstudios.com
 HLC000035

Avenir - Site Plan #3
 A Planned Community Development
 Palm Beach Gardens, Florida
 Landscape Plans - Pod 6

LP-8
 of 36

North
 0 15' 30' 60'
 Scale: 1" = 30'-0"

Date: February 2019
 Project No.: 12-065.003
 Designed By: TP
 Drawn By: WV/JB/BB
 Checked By: KT

Revision Dates:
 02/13/19 PBG Submittal
 05/24/19 PBG Resubmittal
 08/16/19 PBG Resubmittal
 09/20/19 PBG Resubmittal
 10/31/19 PBG Resubmittal
 02/21/20 PBG Resubmittal
 04/08/20 PBG Resubmittal
 04/27/20 PBG Resubmittal

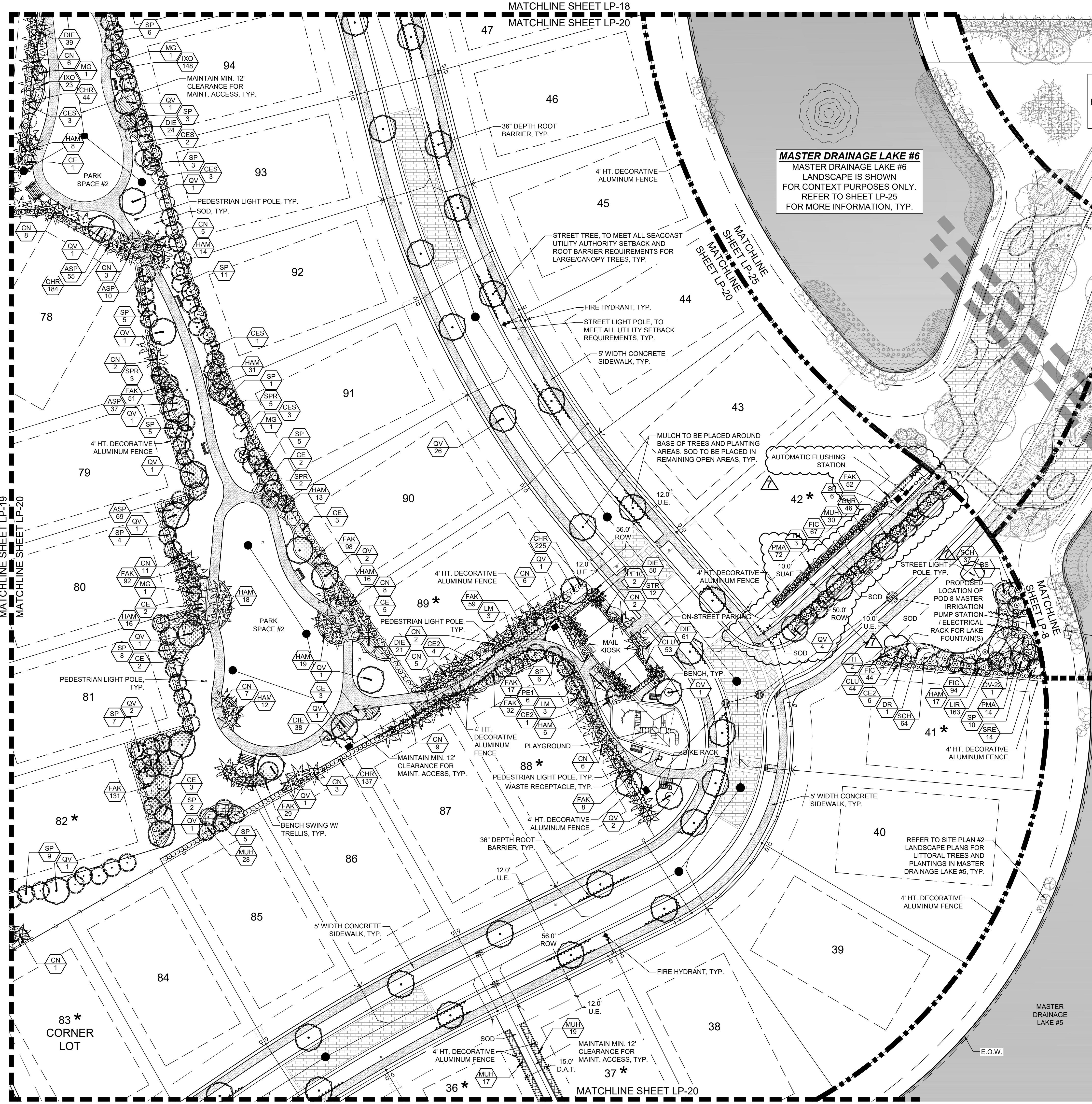

POD 6 (RESIDENTIAL)
 POD 6 LANDSCAPE IS SHOWN
 FOR CONTEXT PURPOSES ONLY.
 REFER TO SHEET LP-8
 FOR MORE INFORMATION, TYP.

MASTER DRAINAGE LAKE #6
 MASTER DRAINAGE LAKE #6
 LANDSCAPE IS SHOWN
 FOR CONTEXT PURPOSES ONLY.
 REFER TO SHEET LP-25
 FOR MORE INFORMATION, TYP.

MASTER DRAINAGE LAKE #5
 MASTER DRAINAGE LAKE #5
 LANDSCAPE IS SHOWN
 FOR CONTEXT PURPOSES ONLY.
 REFER TO SHEET LP-25
 FOR MORE INFORMATION, TYP.

PROPOSED
 LOCATION OF
 POD 8 MASTER
 IRRIGATION
 PUMP STATION
 / ELECTRICAL
 RACK FOR LAKE
 FOUNTAIN(S)

SHEET KEY

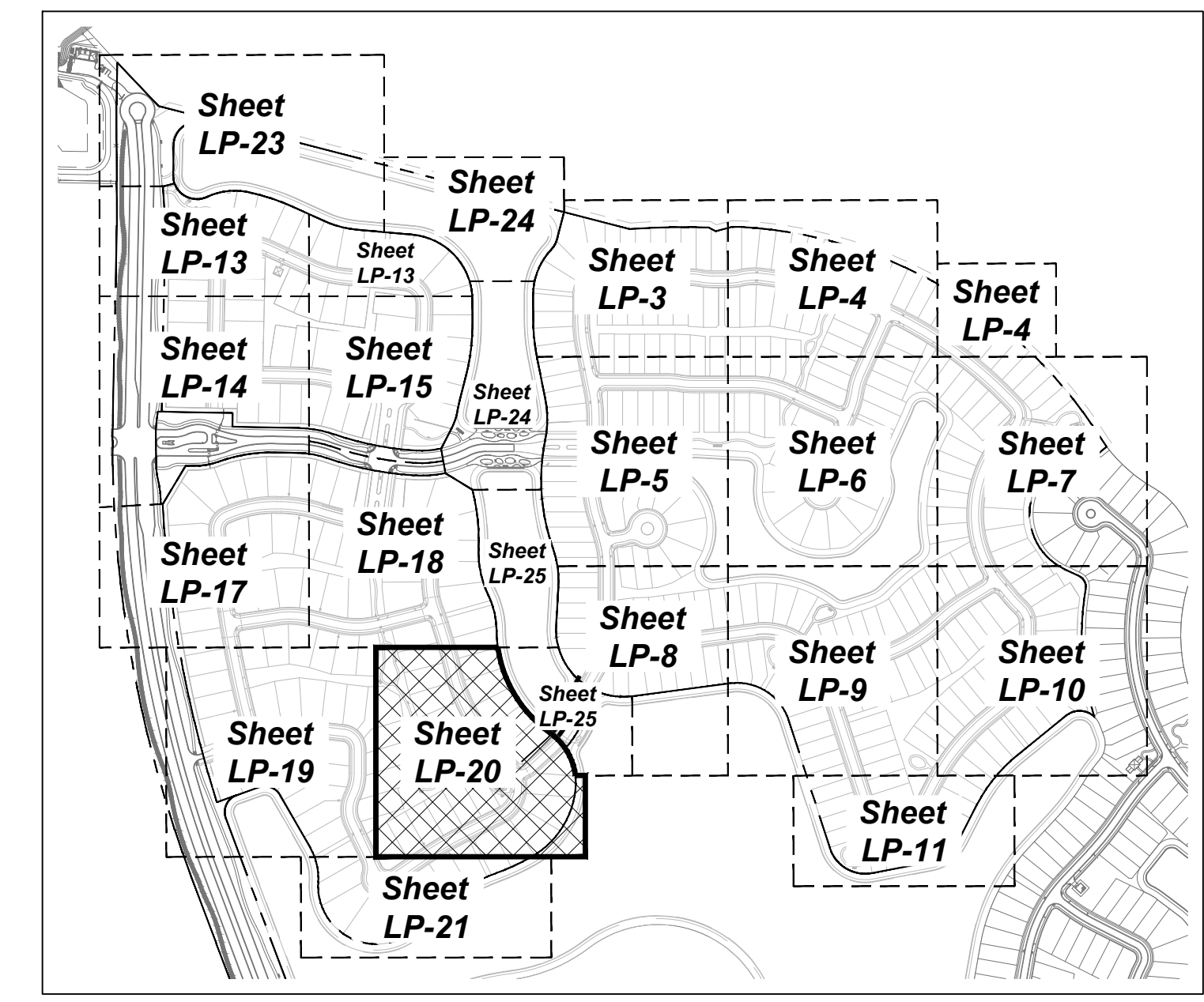

PLANT LEGEND

TREES	CODE	BOTANICAL / COMMON NAME
	BS	Bursera simaruba / Gumbo Limbo Container grown, 12' Ht. x 5' Spr., 2.5" Cal., Straight trunk, Full Canopy
	CE	Coccoloba erecta / Green Button Wood 8 & B, 12' Ht. x 5' Spr., 2.5" Cal., Single Straight Trunk, Full Canopy
	CE2	Coccoloba erecta serotina / Silver Button Wood 8 & B, 12' Ht. x 5' Spr., 2.5" Cal., Straight Trunk, Full Canopy
	CE3	Coccoloba erecta serotina / Silver Button Wood / Multi Trunk 8 & B, 12' Ht. x 5' Spr., 2.5" Cal., Straight Trunk, Full Canopy
	DR	Dioscorea regia / Royal Poinciana Container grown, 12' Ht. x 5' Spr., 2.5" Cal., Single trunk, Full Canopy
	LM	Ligustrum x Muscogee / Lavender Grape Myrtle Multi Trunk Container Grown, 12' Ht. x 5' Min. Spr., Min. 5' Clear Trunk, 2.5" Cal., Multi Trunk, Wide Canopy, Lavender Blooms
	L	Ligustrum japonicum / Japanese Privet Container Grown, 6' Ht. x 5' Spr., Full and Dense Crown
	MG	Magnolia grandiflora / G.D. Blanchard / TM Southern Magnolia Container Grown, 12' Ht. x 5' Spr., 2.5" Cal., Straight Trunk, Full Dense Canopy
	QV	Quercus virginiana / Southern Live Oak Container Grown, 12' Ht. x 5' Spr., 2.5" Cal., Straight Trunk, Full Canopy
	QV22	Quercus virginiana / Southern Live Oak Ranch / Country Oak, 12' Cal. Min. To Be Selected and Tagged by Landscape Architect, 5' C.M.
	TH	Tabebuia heterophylla / Pink Tabebuia Container Grown, 12' Ht. x 5' Spr., 2.5" Cal., Single Straight Trunk, Full Canopy
PALM TREES	CODE	BOTANICAL / COMMON NAME
	CN	Coccothrinax crinita / Green Majesty / Coconut Palm Field Grown, 20' CT, Florida Fan, Classic cut, No Scared Trunk
	PD	Phoenix dactyloides / Medjool / Date Palm Field Grown, 20' CT, Florida Fan, Classic cut, Matched Hts., Full Crown
	PE10	Phycosperma elegans / Alexander Palm Field Grown, Tripe, Minimum 10' CW
	PE1	Phycosperma elegans / Alexander Palm Field Grown, Single, Varying Heights, Minimum 12' CW, Full Crown
	SP	Sabal palmetto / Cabbage Palmetto Field Grown, Varying Heights, 12-18' CT, Slick Straight Trunk, Hurricane Cut
	SPR	Sabal palmetto / Curved Trunk Sabal Palm Field Grown, Varying Heights, 15-20' CT, Slick Trunk, Curved, Hurricane Cut
SHRUBS	CODE	BOTANICAL / COMMON NAME
	CHR	Chrysolepis canescens / Sweet Tea / Field Tea Cuscutum 3 Gal., 18" Ht. x 12" Spr., 30" O.C., Full to Base and Dense
	CLU	Clusia guifera / Small-Leaf Clusia 3 Gal., 18" Ht. x 18" Spr., 30" O.C., Full and Dense
	CRI	Citrus aurantium / Queen Emma / Queen Emma / Citrus 7 Gal., 1 PPM, 3' Ht. x 2' Spr., Disease Free, Specimen
	PMA	Panicum macrophyllum / Yew Pine 7 Gal., 42" Ht. x 24" Spr., Full to Base and Dense
	RE	Reynoldsia repens / Saw Palmetto 3 Gal., 18" Ht. x 18" Spr., Min., Full and Dense, Full to Base
	STR	Strelitzia reginae / Bird of Paradise 7 Gal., 36" Ht. x 24" Spr., 2-3 PPM, Full and Dense
SHRUB AREAS	CODE	BOTANICAL / COMMON NAME
	ASP	Aspidistra elatior / Meyer / Fossil Fern 3 Gal., 14" Ht. x 14" Spr., 24" O.C.
	DE	Dioscorea indivisa / White African Iris 3 Gal., 18" Ht. x 15" Spr., 30" O.C., Fully Rooted and Dense
	FIC	Ficus microcarpa / Green Island / Green Island Ficus 3 Gal., 12" Ht. x 10" Spr., 24" O.C., Fully Rooted and Dense
	HAM	Hamelia patens / Fire Bush 5 Gal., 24" Ht. x 15" Spr., 48" O.C., Full and Dense
	RO	Rosa 'Nova Grant' / Ives 3 Gal., 18" Ht. x 18" Spr., 24" O.C., Full to Base, Dense, Red
	JAS	Jasminum volatile / Wax Jasmine 3 Gal., 12" Ht. x 12" Spr., 30" O.C., Full and Dense, Full to Base
	SCH	Scaevola arborescens / Tinetti / Scaevola 3 Gal., 12" Ht. x 12" Spr., 24" O.C., Full to Base and Dense
GRASSES	CODE	BOTANICAL / COMMON NAME
	LR	Liriodendron / Emerald Goddess / Liriodendron 1 Gal., 12" Ht. x 12" Spr., 18" O.C., Full to Edge of Pot
	MUH	Muhlenbergia capillaris / Pink Muffy Grass 1 Gal., 24" Ht. x 22" Spr., 36" O.C., Fully Rooted and Dense
	SPA	Sporobolus bakeri / Sand Cord Grass 1 Gal., 24" Ht. x 22" Spr., 36" O.C., Fully Rooted and Dense
	FA	Festuca arundinacea / Fawnflecked Grass 1 Gal., 24" Ht. x 22" Spr., 36" O.C., Fully Rooted and Dense
GROUND COVERS	CODE	BOTANICAL / COMMON NAME
	ANN	Annuals / Annuals 4" Pot, 10" O.C. (Variety to be determined by Owner at time of planting)
	POP	Panicum macrophyllum / Dwarf Pigeon / Dwarf Pigeon Container Grown, 17" Ht. x 12" Spr., Min. 24" O.C., Fully Rooted and Dense
	TRA	Trichostema aestivum / Mimosa Jasmine 1 Gal., 12" Ht. x 12" Spr., 18" O.C., Full to Edge of Pot
SOD / TURF	CODE	BOTANICAL / COMMON NAME
	SOD	Stenotaphrum secundatum / Floratone / St. Augustine Sod Disease Free, Leaf Tightly Disengaged Joints, Rolled and Shaded to Level Lawn. Quantity to be Verified in the Field

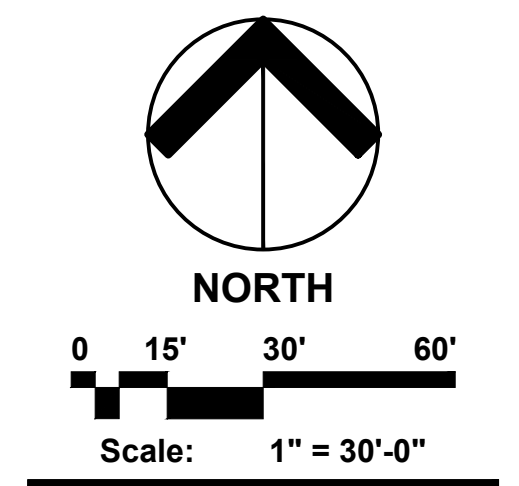

Date: February 2019
 Project No.: 12-065.003
 Designed By: TP
 Drawn By: WV/JB/BB
 Checked By: KT

Revision Dates:

02/13/19	PBG Submittal
05/24/19	PBG Resubmittal
08/16/19	PBG Resubmittal
09/20/19	PBG Resubmittal
10/31/19	PBG Resubmittal
02/21/20	PBG Resubmittal
04/08/20	PBG Resubmittal
04/27/20	PBG Resubmittal

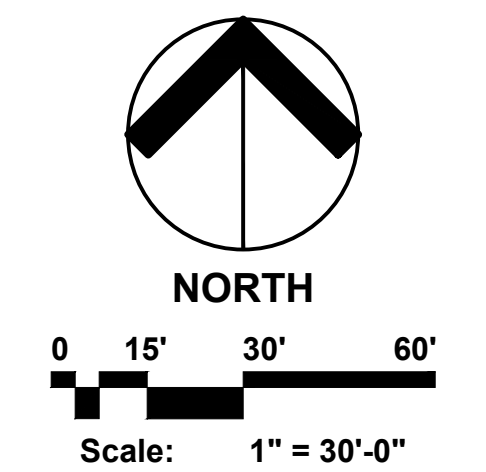

Date: February 2019
Project No.: 12-065.003
Designed By: TP
Drawn By: WV/JB/BB
Checked By: KT

Revision Dates:

02/13/19	PBG Submittal
05/24/19	PBG Resubmittal
08/16/19	PBG Resubmittal
09/20/19	PBG Resubmittal
10/31/19	PBG Resubmittal
02/21/20	PBG Resubmittal
04/06/20	PBG Resubmittal
04/27/20	PBG Resubmittal

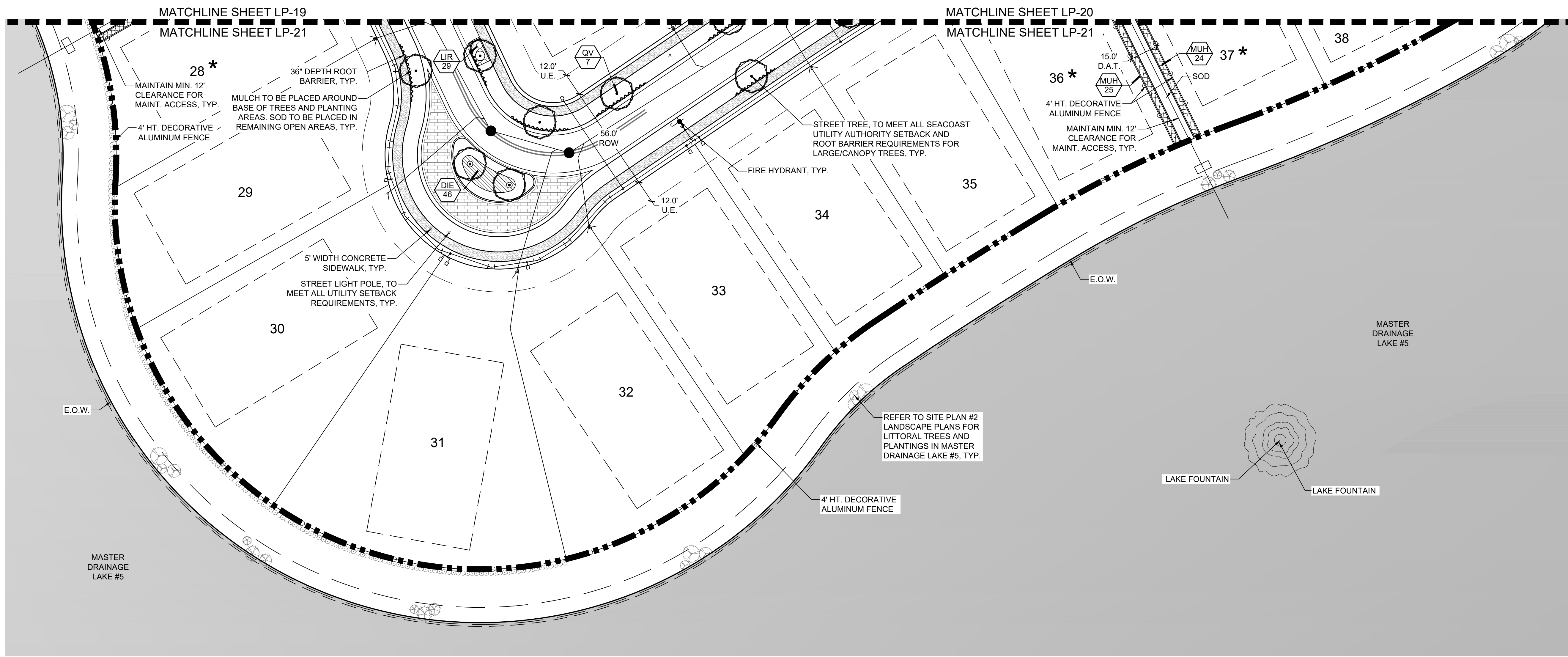

PLANT LEGEND

TREES	CODE	BOTANICAL / COMMON NAME	RAM	BOTANICAL / COMMON NAME
	BS	Bursera simaruba / Cumbo Limbo Container grown, 12' Ht. x 5' Spr., 2.5' Cal., Straight trunk, Full Canopy		Hemelia jamaicensis 1 Gal., 12' Ht. x 10' Spr., 45" O.C., Full and Dense
	DE	Conocarpus erectus / Green Button Wood B&B, 12' Ht. x 5' Spr., 2.5' Cal., Single Straight Trunk, Full Canopy		Isora / Nora Grand / Isora 3 Gal., 18' Ht. x 18' Spr., 24" O.C., Full to Base, Dense, Red
	GE2	Conocarpus erectus sericeus / Silver Button Wood B&B, 12' Ht. x 5' Spr., 2.5' Cal., Straight Trunk, Full Canopy		Jasminum volubile / Wax Jasmine 3 Gal., 12' Ht. x 12' Spr., 30" O.C., Full and Dense, Full to Base
	GES	Conocarpus erectus sericeus / Silver Button Wood / Multi Trunk B&B, 12' Ht. x 5' Spr., 2.5' Cal., Straight Trunk, Full Canopy		Schefflera atrovirens / Treelet / Schefflera 3 Gal., 18' Ht. x 15' Spr., 24" O.C., Full to Base and Dense
	DR	Dorstenia regia / Royal Poinciana Container grown, 12' Ht. x 5' Spr., 2.5' Cal., Single trunk, Full Canopy		SPERMATOPHYTES / COMMON NAME
	LM	Lagerströmia / Maitland / Lavender Crisp Myrtle Multi Trunk Container Grown, 12' Ht. x 5' Min. Spr., Min. 5' Clear Trunk, 2.5' Cal., Multi-Trunk, Wide Canopy, Lavender Blooms		Liriodendron muscari / Emerald Goddess / Liriodendron 1 Gal., 12' Ht. x 12' Spr., 18" O.C., Full to Edge of Pot
	LI	Ligustrum japonicum / Japanese Privet Container Grown, 6' Ht. x 5' Spr., Full and Dense Crown		Muhlenbergia capillaris / Pink Murly Grass 1 Gal., 24" Ht. x 22" Spr., 36" O.C., Fully Rooted and Dense
	MG	Magnolia grandiflora / D.D. Burchard / Southern Magnolia Container Grown, 12' Ht. x 5' Spr., 3" CT, Straight Trunk, Full Dense Canopy		SPERMATOPHYTES / COMMON NAME
	QV	Quercus virginiana / Southern Live Oak Container Grown, 12' Ht. x 5' Spr., 2.5' Cal., Straight Trunk, Full Canopy		SPERMATOPHYTES / COMMON NAME
	QV-2	Quercus virginiana / Southern Live Oak Ranch / Country Oak, 12' Cal. Min., To Be Selected and Tagged by Landscape Architect, 8" CT Min.		SPERMATOPHYTES / COMMON NAME
	TH	Tabebuia heterophylla / Pink Tabebuia Container Grown, 12' Ht. x 5' Spr., 2.5' Cal., Single Straight Trunk, Full Canopy		SPERMATOPHYTES / COMMON NAME
	PALM TREES			GROUND COVERS
	CN	Coccothrinax / Green Majesty / Coconut Palm Field Grown, Varying Heights, 8"-12" CW, Full Head, No Scarred Trunk		ANN Annuals / Annuals 4" Pots, 10" O.C. (Variety to be determined by Owner at time of planting)
	PD	Phoenix dactylifera / Medjool / Date Palm Field Grown, 20' CT, Florida Fancy, Classic cut, Matched Hts., Full Crown		PCP Podocarpus macrophyllus / Dwarf Fir / Fir Lowest Podocarpus Container Grown, 15" Ht. x 12" Spr. Min., 24" OC, Fully Rooted and Dense
	RE10	Phycosperma elegans / Alexander Palm Field Grown, Triple, Minimum 10' CW		TRA Trisetosperum asiaticum / Mimosa / Mimosa 1 Gal., 12' Ht. x 12' Spr., 18" O.C., Full to Edge of Pot
	RE1	Phycosperma elegans / Alexander Palm Field Grown, Single, Varying Heights, Minimum 12' CW, Full Crown		SOD / TURF SOD Stenotaphrum secundatum / St. Augustine / St. Augustine Disease Free, Laid Tightly w/ Staggered Joints, Rolled and Sandbed to Level Lawn. Quantity to be Verified in the Field.
	SP	Sabal palmetto / Cabbage Palmetto Field Grown, Varying Heights, 12'-18" CT, Stick Straight Trunk, Hurricane Cut		
	SPR	Sabal palmetto / Curved Trunk Sabal Palm Field Grown, Varying Heights, 15'-20" CT, Stick Trunk, Curved, Hurricane Cut		
	SHRUBS			
	CHR	Chrysothamnus nauseosus / Red Tip / Red Tip Coccoloba 1 Gal., 18" Ht. x 12" Spr., 30" O.C., Full to Base and Dense		
	CLU	Clusia grandifolia / Spanish Cedar 3 Gal., 18" Ht. x 18" Spr., 30" O.C., Full and Dense		
	CR	Crinum augustinum / Queen Emma / Queen Emma 7 Gal., 1 PFP, 3' Ht. x 3' Spr., Disease Free, Specimen		
	PMA	Podocarpus macrophyllus / Yew Pine 7 Gal., 48" Ht. x 24" Spr., Full to Base and Dense		
	SRE	Scaevola taccada / Saw Palmetto 3 Gal., 18" Ht. x 18" Spr. Min., Full and Dense, Full to Base		
	SIR	Stereosia rogersii / Bird Of Paradise 7 Gal., 36" Ht. x 24" Spr., 2-3 PFP, Full and Dense		
	SHRUB AREAS			
	ASP	Asparagus densiflorus / Meyer's / Foxtail Fern 1 Gal., 14" Ht. x 14" Spr., 24" O.C.		
	DIE	Dioscorea escholtzii / White African Iris 3 Gal., 18" Ht. x 15" Spr., 30" O.C. Fully Rooted and Dense		
	IC	Ficus microcarpa / Green Island / Green Island Ficus 3 Gal., 12" Ht. x 10" Spr., 24" O.C., Fully Rooted and Dense		

SHEET KEY

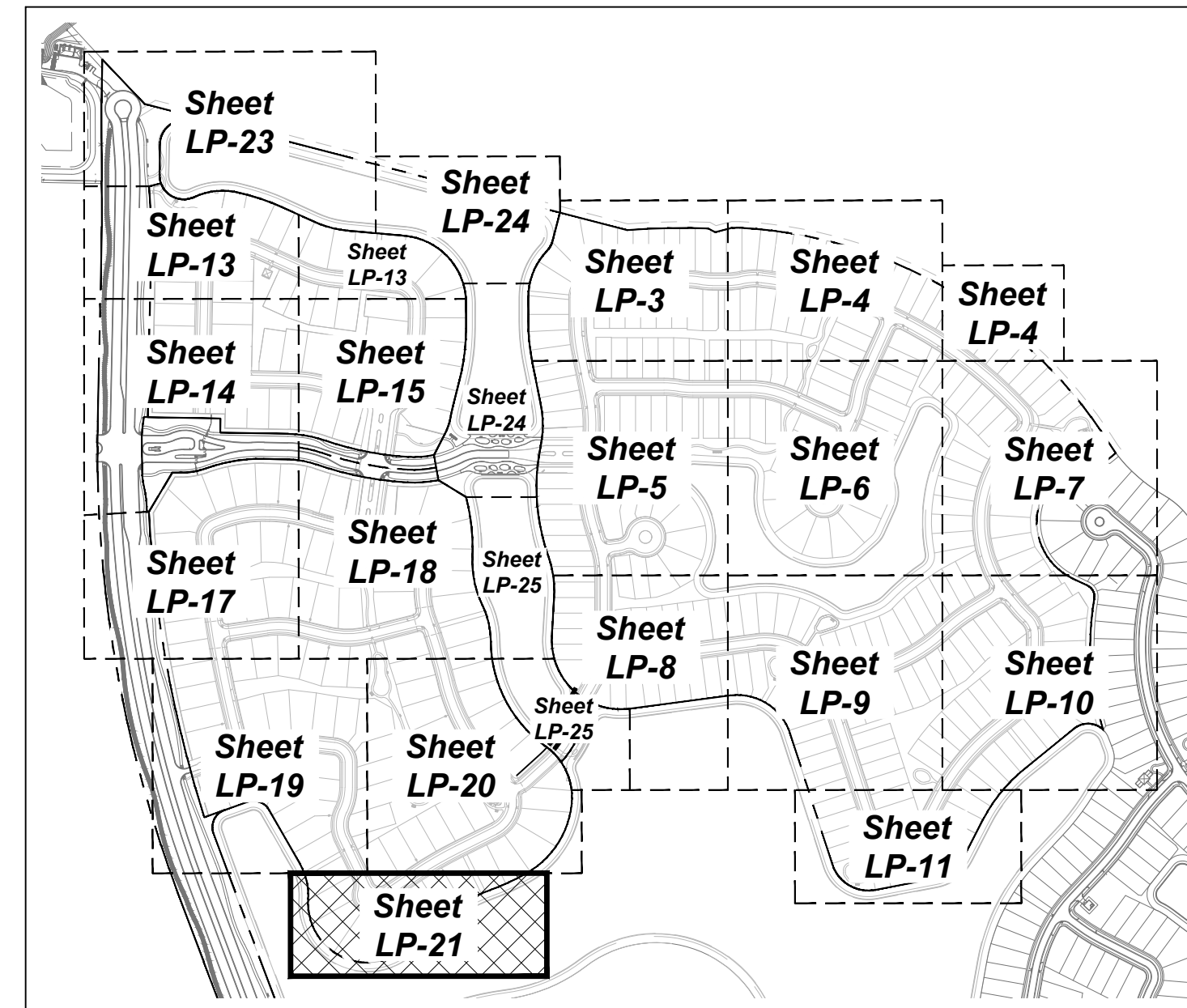

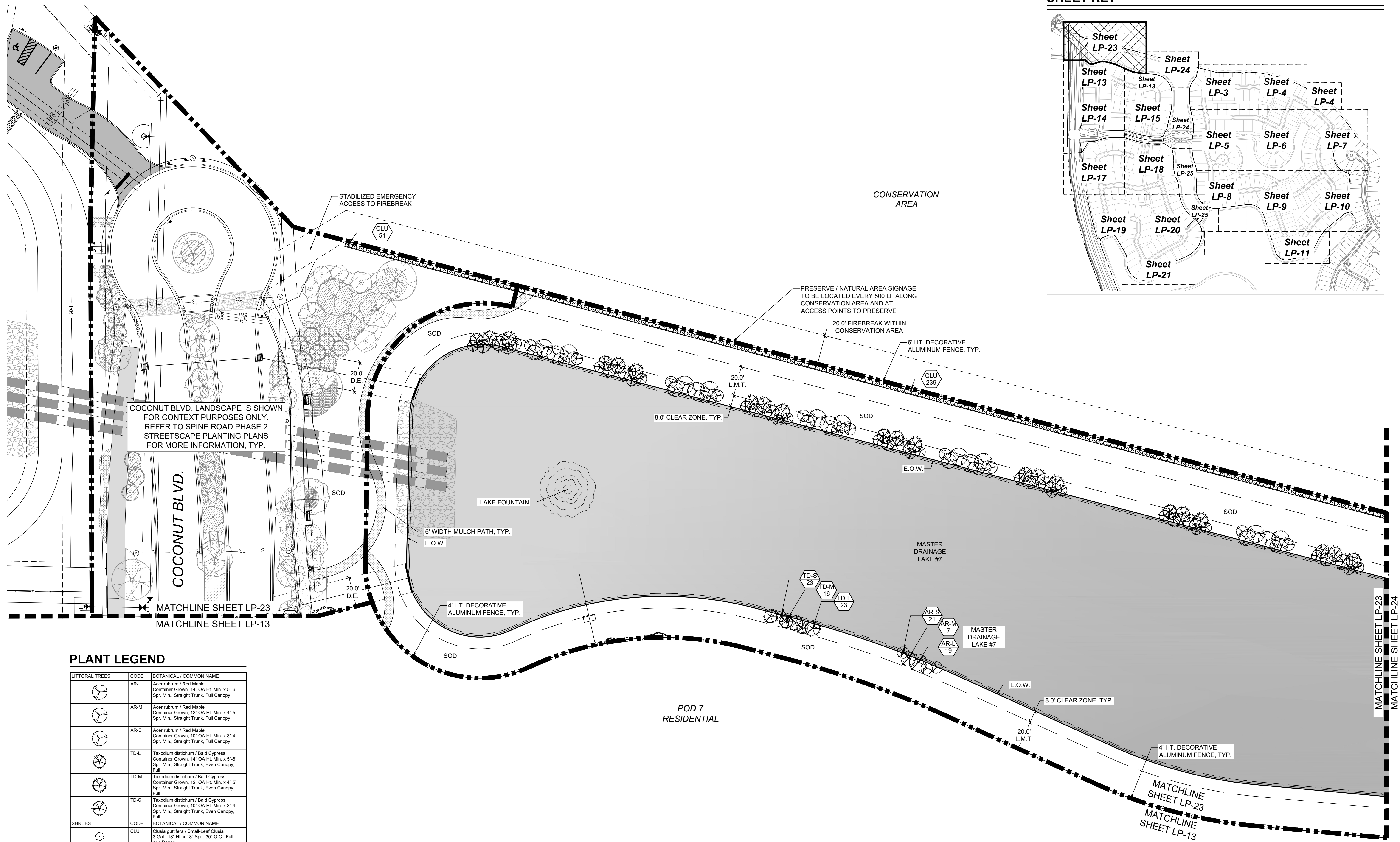

SHEET KEY

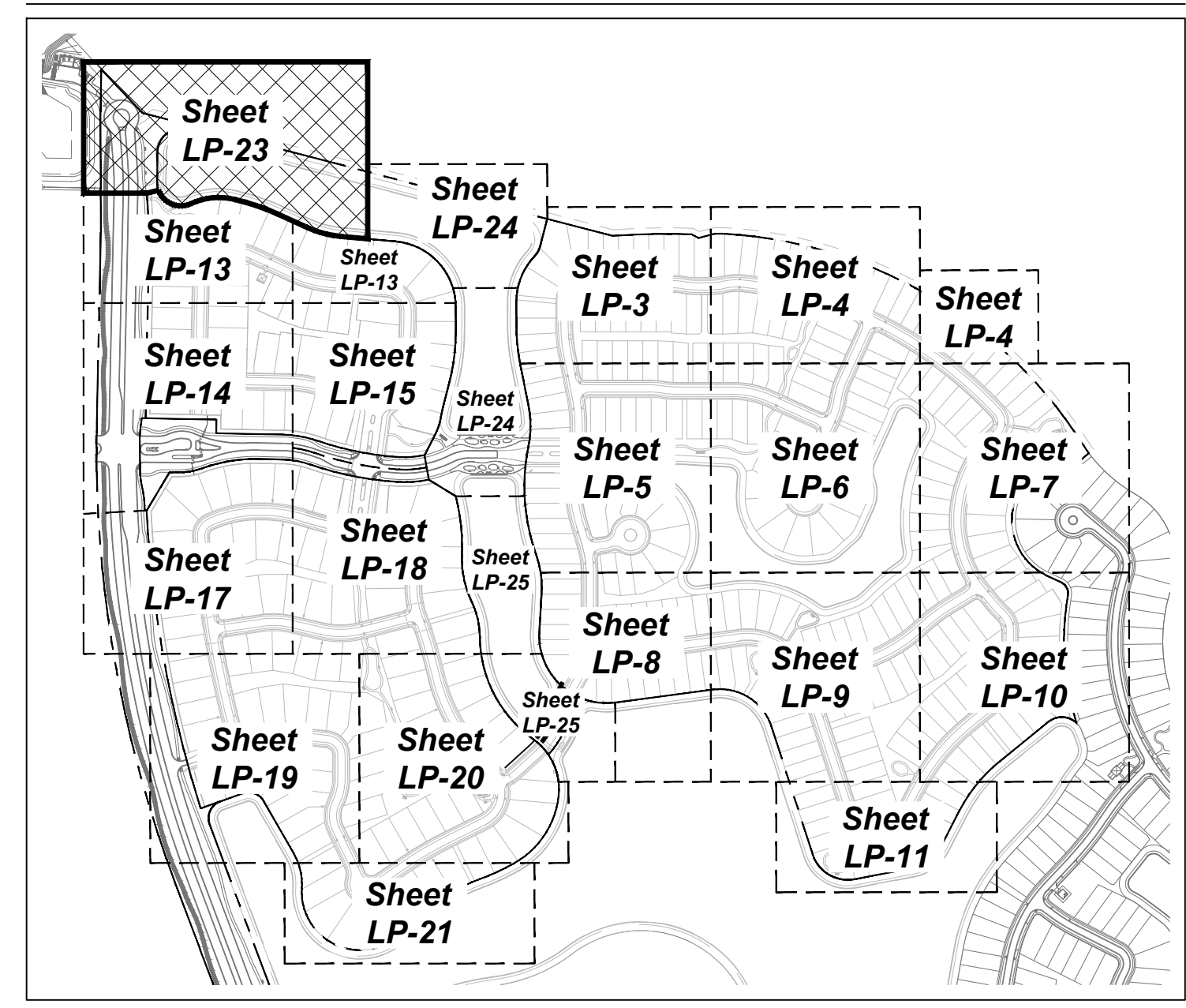

COCONUT BLVD. LANDSCAPE IS SHOWN FOR CONTEXT PURPOSES ONLY. REFER TO SPINE ROAD PHASE 2 STREETSCAPE PLANTING PLANS FOR MORE INFORMATION, TYP.

PLANT LEGEND

LITTORAL TREES		CODE	BOTANICAL / COMMON NAME
	AR-L	Acer rubrum / Red Maple Container Grown, 14" OA Ht. Min. x 5'-6" Spr. Min., Straight Trunk, Full Canopy	
	AR-M	Acer rubrum / Red Maple Container Grown, 12" OA Ht. Min. x 4'-5" Spr. Min., Straight Trunk, Full Canopy	
	AR-S	Acer rubrum / Red Maple Container Grown, 10" OA Ht. Min. x 3'-4" Spr. Min., Straight Trunk, Full Canopy	
	TD-L	Taxodium distichum / Bald Cypress Container Grown, 14" OA Ht. Min. x 5'-6" Spr. Min., Straight Trunk, Even Canopy, Full	
	TD-M	Taxodium distichum / Bald Cypress Container Grown, 12" OA Ht. Min. x 4'-5" Spr. Min., Straight Trunk, Even Canopy, Full	
	TD-S	Taxodium distichum / Bald Cypress Container Grown, 10" OA Ht. Min. x 3'-4" Spr. Min., Straight Trunk, Even Canopy, Full	
SHRUBS		CODE	BOTANICAL / COMMON NAME
	CLU	Clusia guttata / Small-Leaf Clusia 3 Gal., 18" Ht. x 18" Spr., 30" O.C., Full and Dense	
LITTORAL PLANTINGS		CODE	BOTANICAL / COMMON NAME
	CAN	Canna flaccida / Yellow Canna Bare Root, Min. 12" Ht., 3-4 Stems Per Plant, 24" O.C., Full Erect Foliage	
	AME	Cyperus americanus / Swamp Lily Bare Root, Min. 12" Ht., 3-4 Stems Per Plant, 24" O.C., Full Erect Foliage	
	ELE	Eleocharis interstincta / Jointed Spikerush Bare Root, Min. 12" Ht., 3-4 Stems Per Plant, 24" O.C., Full Erect Foliage	
	PON	Pontederia cordata / Pickerel Weed Bare Root, Min. 12" Ht., 3-4 Stems Per Plant, 24" O.C., Full Erect Foliage	
	SOD	Stenotaphrum secundatum "Floratum" / St. Augustine Sod Disease Free, Laid Tightly w/ Staggered Joints, Rolled and Sanded to Level Lawn *Quantity to be Verified in the Field	
NO SYMBOL	SOD	Stenotaphrum secundatum "Floratum" / St. Augustine Sod Disease Free, Laid Tightly w/ Staggered Joints, Rolled and Sanded to Level Lawn *Quantity to be Verified in the Field	

Avenir - Site Plan #3
A Planned Community Development
Palm Beach Gardens, Florida
Landscape Plans - Master Drainage Lakes

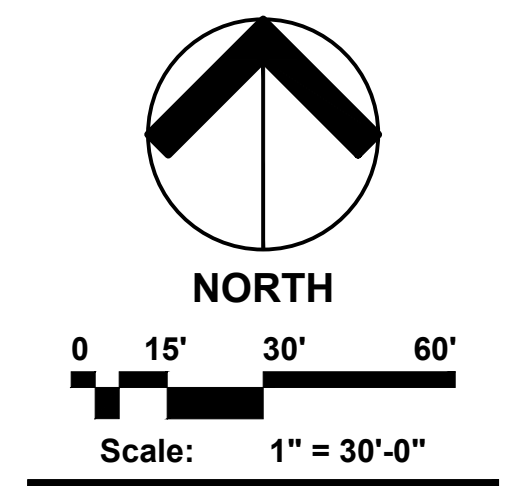

Date: February 2019
Project No.: 12-065.003
Designed By: TP
Drawn By: WV/JB/BB
Checked By: KT

Revision Dates:

02/13/19	PBG Submittal
05/24/19	PBG Resubmittal
08/16/19	PBG Resubmittal
09/20/19	PBG Resubmittal
10/31/19	PBG Resubmittal
02/21/20	PBG Resubmittal
04/06/20	PBG Resubmittal
04/27/20	PBG Resubmittal

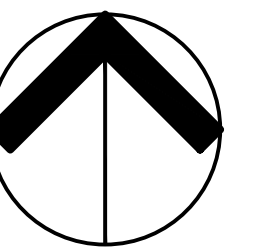

0 15' 30' 60'
Scale: 1" = 30'-0"

Date: February 2019
Project No.: 12-065.003
Designed By: TP
Drawn By: WW/JB/BB
Checked By: KT

Revision Dates:

02/13/19	PBG Submittal	▲
05/24/19	PBG Resubmittal	▲
08/16/19	PBG Resubmittal	▲
09/20/19	PBG Resubmittal	▲
10/31/19	PBG Resubmittal	▲
02/21/20	PBG Resubmittal	▲
04/06/20	PBG Resubmittal	▲
04/27/20	PBG Resubmittal	▲

PLANT LEGENDS

MASTER DRAINAGE LAKES

LITTORAL TREES	CODE	BOTANICAL / COMMON NAME
	AR-L	Acer rubrum / Red Maple Container Grown, 14" OA Ht. Min. x 5'-5" Spr. Min., Straight Trunk, Full Canopy
	AR-M	Acer rubrum / Red Maple Container Grown, 12" OA Ht. Min. x 4'-5" Spr. Min., Straight Trunk, Full Canopy
	AR-S	Acer rubrum / Red Maple Container Grown, 10" OA Ht. Min. x 3'-4" Spr. Min., Straight Trunk, Full Canopy
	TD-L	Taxodium distichum / Bald Cypress Container Grown, 14" OA Ht. Min. x 5'-6" Spr. Min., Straight Trunk, Even Canopy, Full
	TD-M	Taxodium distichum / Bald Cypress Container Grown, 12" OA Ht. Min. x 4'-5" Spr. Min., Straight Trunk, Even Canopy, Full
	TD-S	Taxodium distichum / Bald Cypress Container Grown, 10" OA Ht. Min. x 3'-4" Spr. Min., Straight Trunk, Even Canopy, Full
SHRUBS	CODE	BOTANICAL / COMMON NAME
	CLU	Clusia guttata / Small-Leaf Clusia 3 Gal., 18" Ht. x 18" Spr., 30" O.C., Full and Dense
LITTORAL PLANTINGS	CODE	BOTANICAL / COMMON NAME
	CAN	Canina fasciata / Yellow Canina Bare Root, Min. 12" Ht., 3-4 Stems Per Plant, 24" O.C., Full Erect Foliage
	AME	Crinum americanum / Swamps Lily Bare Root, Min. 12" Ht., 3-4 Stems Per Plant, 24" O.C., Full Erect Foliage
	ELE	Eleocharis interstincta / Jointed Spikerush Bare Root, Min. 12" Ht., 3-4 Stems Per Plant, 24" O.C., Full Erect Foliage
	PON	Pontederia cordata / Pickerel Weed Bare Root, Min. 12" Ht., 3-4 Stems Per Plant, 24" O.C., Full Erect Foliage
SOD / TURF	NO SYMBOL	SOD
		Stenotaphrum secundatum "Floratum" / St. Augustine Sod Disease Free, Laid Tightly w/ Staggered Joints, Rolled and Sandbed to Level Lawn *Quantity to be Verified in the Field

PODS 6 AND 8 BRIDGE

TREES	CODE	BOTANICAL / COMMON NAME
	BS2	Bursera simaruba / Gumbo Limbo Field Grown, 6" Cal., 16" Ht. x 10' Spr., 6" CT Min., Single Trunk, Full Canopy
	BS3	Bursera simaruba / Gumbo Limbo Field Grown, 9" Cal., 18" Ht. x 12' Spr., 6" CT Min., Single Trunk, Full Canopy
	QV-9	Quercus virginiana / Southern Live Oak Ranch / Country Oak, 9" Cal. Min., To Be Selected and Tagged by Landscape Architect, 8" CT Min.
	QV-12	Quercus virginiana / Southern Live Oak Ranch / Country Oak, 12" Cal. Min., To Be Selected and Tagged by Landscape Architect, 8" CT Min.
PALM TREES	CODE	BOTANICAL / COMMON NAME
	SP	Sabal palmetto / Cabbage Palmetto Field Grown, Varying Heights, 12'-18" CT, Slick Straight Trunk, Hurricane Cut
SHRUBS	CODE	BOTANICAL / COMMON NAME
	SRE	Serenoa repens / Saw Palmetto 3 Gal., 18" Ht. x 18" Spr. Min., Full and Dense, Full to Base
SHRUB AREAS	CODE	BOTANICAL / COMMON NAME
	CHR1	Chrysobalanus icaco / Red Tip / Red Tip Cocoplum 3 Gal., 18" Ht. x 12" Spr., 24" O.C., Full to Base and Dense
	FIC	Ficus microcarpa / Green Island / Green Island Ficus 3 Gal., 12" Ht. x 10" Spr., 24" O.C., Fully Rooted and Dense
	HAM	Hamelia patens / Fire Bush 1 Gal., 12" Ht. x 10" Spr., 48" O.C., Full and Dense
GRASSES	CODE	BOTANICAL / COMMON NAME
	FAK	Tripsacum dactyloides / Fakahatchee Grass 1 Gal., 24" Ht. x 22" Spr., 36" O.C., Fully Rooted and Dense
GROUND COVERS	CODE	BOTANICAL / COMMON NAME
	EVO	Evolvulus glomeratus / Blue Daze / Blue Daze 1 Gal., 6" Ht. x 6" Spr., 18" O.C., Full
	NEX	Nephrolepis exaltata / Florida Sword Fern 3 Gal., 24" Ht. x 18" Spr., 24" O.C., Full and Dense, Full to Edge of Pot
SOD / TURF	NO SYMBOL	SOD
		Stenotaphrum secundatum "Floratum" / St. Augustine Sod Disease Free, Laid Tightly w/ Staggered Joints, Rolled and Sandbed to Level Lawn; *Quantity to be Verified in the Field

SHEET KEY

