

AVENIR CDD

PHASE ONE AND PHASE TWO

Landscape Maintenance Presentation
2024

Rich Ingram
rich.ingram@brightview.com
561-445-2076

The BrightView Difference

When you partner with BrightView, you have our commitment that we will manage your property and complete work on time and within budget. We provide the right equipment and manpower to perform any landscape project. Our team will take the same ownership, pride in the community and having all team members keep the site consistently looking like the residents expect. **Included in our price are services that are a resource to the community and are no additional charge for selecting BrightView as your trusted landscape advisor.**

✓ **COMPANY HISTORY | LEGACY**
80+ years in the landscape industry: Design | Develop | Maintain | Enhance

✓ **ACTION PLAN | HORTICULTURAL ASSESSMENT | LANDSCAPE REPORT**
BrightView follows a written step by step process of how the management of your landscape requirements will be executed.

✓ **TRAINED SKILLED CLIENT SERVICE TEAMS**
800+ Employees in South Florida Trained; Skilled in all levels of landscape management

✓ **TENURE OF MANAGEMENT STAFF**
Unmatched 15-year average management tenure in our South Florida Branches.

✓ **IN HOUSE TECHNICAL SERVICE**
All of the technical services with regard to managing your landscape will require no third party involvement.

✓ **COMMUNICATION REPORTING TOOLS**
A Quality Services Assessment report will be done regularly as well as Irrigation Reports, Fertilization and Lawn and Ornamental Pest reports and logs for our Service Activities

✓ **DIGITAL ENHANCEMENTS**
4 Local Landscape Designers to provide renderings of landscape improvements

✓ **EMERGENCY STORM PLANNING**
With over 3000 employees in Florida we have proven that we are uniquely qualified to mobilize for hurricane recovery.



Committed to Your Success at Every Stage of Your Landscape

Design

Forward-thinking, constructible design that considers future operating costs

Develop

Seamless project delivery that meets your goals and long-term expectations, on-time and on-budget

One Partner

to take care of you and all your landscape needs.

Enhance

Thoughtful improvements to enrich your landscape's appearance and sustainability

Maintain

Consistent service delivery and proactive solutions that keep your property at its best, now and in the future

Design

- Landscape Architecture & Planning
- Design-Build
- Program Management
- Irrigation

Develop

- Planting
- Hardscapes
- Pools & Water Features
- Compliance
- Tree Growing & Moving

Maintain

- Landscape
- Tree Care
- Specialty Turf
- Exterior Maintenance

Enhance

- Enhancements
- Sustainability
- Water Management

A Trusted Advisor

SERVICES

Design

- Landscape Arch. & Planning
- Design-Build
- Program Management

Develop

- Planting
- Hardscapes
- Pools & Water Features
- Compliance
- Tree Growing & Moving

Maintain

- Landscape
- Tree Care
- Specialty Turf
- Exterior Maintenance

Enhance

- Enhancements
- Sustainability
- Water Management

OFFICES

Wellington

13701 Okeechobee BLVD
Loxahatchee, FL 33470

Fort Lauderdale

- 2711 SW 36th Street
- Fort Lauderdale, FL. 33312

Pembroke Pines

- 6941 SW 196th Avenue
- Suite 30
- Pembroke Pines FL. 33332

Boca Raton

11600 S Military TRL.BLD J
Village of Golf, FL

EMPLOYEES

Sunrise

- 220 Gardeners
- 10 Supervisors
- 7 Certified Technicians

Dania Beach

- 210 Gardeners
- 17 Supervisors
- 8 Certified Technicians

Pembroke Pines

- 150 Gardeners
- 10 Supervisors
- 5 Certified Technicians

Boca Raton

- 190 Gardeners
- 9 Supervisors
- 6 Certified Technicians

FACTS

Years in Business

- Since 1939
- Over 80 years

Florida Corporation

- BrightView Landscape Services, Inc.
- FEIN #: 95-419223

Insurance

- Aon Risk Services
- General Commercial
- Auto & Workman's Comp

Bonding Ability

- Aon Risk Services
- Excess of \$200 Million
- \$25 million for single project

A Trusted Advisor

LICENSES

Maintenance

- FNGLA Certified Maintenance Technicians
- BMP Train the Trainer

Irrigation

- Florida Certified Plumbers
- Irrigation Association Member
- Smart Water Irrigation

Pest & Disease

- Florida Certified Operators
- Florida Certified Applicators
- Florida Certified Ag Products

Tree Trimming

- ISA Certified Master Arborist
- ISA Certified Arborist
- TCIA Certified

QUALIFICATIONS

Best Management

- Florida Friendly Landscaping
- Train the Trainer

Emergency Response

- Certified First Responder
- Competent in Training

Storm Water

- Emergency Recovery
- Certified Assessor

Safety

- State Rules and Regulations
- Fall Protection

CERTIFICATIONS

FDOT

- Setup Certified
- Competent Trainer

CPR

- First Aid
- Instructor

OSHA

- Hi Lift Certified
- Osha – 10 card

Horticulturalist

- FNGLA Certified Technicians

DEGREES

Agronomy

- BA | As
- Florida, Penn State

Horticulture

- BA | As
- Florida, Penn State

Business

- BA | As
- FAU | Florida State

Plant Science

- BA | As
- Florida | Rutgers

JOB DESCRIPTIONS

Upper Level Supervisors - Branch Manager and Account Manager

The Branch Manager and Account Manager are the direct contacts and liaisons between your community and our operations team. The Account Manager will communicate with your community's property management team offices daily to ensure all parties are 100% aware of what is happening. They will host quality service assessments, property walks, safety audits and make sure the condition of the property exceeds your standards.

Assistant Branch Manager

The Assistant Branch Manager oversees and directs all field operations and ensures work is being conducted and completed in a manner commensurate with maintenance specifications. They report all closed work orders back to the on site Property Management Team.

Supervisor/Production Manager/Crew Leader

Each field operations team is assigned a Crew Leader who will be on your property every day. The Crew Leader reports any damage and urgent situations to the Account Manager and Property Manager and ensures all necessary items are carried out on a daily basis. They inspect the property daily to uphold quality control standards.

Staff (Field and Landscape Crews)

At the heart of our company are our crews and landscape gardeners. All staff which execute services within this contract and its accompanying exhibits and specifications will be assigned as proprietary staff to your association as opposed to traveling group of staff which perform work on multiple properties. Your team will fulfill all community requests and are directed by the Account Manager, Assistant Manager and Crew Supervisors.

Irrigation Specialist

Irrigation specialists oversee the entire irrigation system at your community. They will be completing wet checks, making repairs and fine tuning the system regularly.

Chemical Applicator

Our chemical applicator treats all participating properties with EPA approved pesticides in accordance with best management practice. They utilize proper fertilization methods that best fit the needs of your property. All fertilization team members are highly trained and licensed.

Install Team (Enhancement Team)

Enhancement teams and our landscape design staff are skilled designers who can visualize and execute cost effective, sustainable landscape solutions to your sites needs. They work with the Account Manager, Landscape Committee, Board and Property Management team to develop designs, renderings and cost estimates.

Additional Resources Available to Our Clients

BrightView's team includes the finest arborists, horticulturists, agronomists, irrigation experts, and designers, many of whom are nationally recognized. Their expertise is available to be shared with our clients as needed.

BrightView Leadership Leadership

Charles Gonzalez: SVP & GM for South Florida

- Over 35 years in Florida's Green Industry
- Certified Green Industry Best Management Practices
- Member of Latin Builders Assoc., Irrigation Assoc., & FNGLA
- Joined BrightView in 1992
- Owned and operated 35th largest landscape company in the U.S.
- Charles.Gonzalez@brightview.com

Jose Zepeda: Senior Branch Manager Palm Beach

- Over 35 years in the Green Industry
- BrightView employee for 15 years
- #1 branch of the year 2018 – BrightView
- B.S. in Horticulture
- Certified Pest Operator and Green Industry Best Management Practices
- Integrated Pest Management Specialist
- Qualified Florida Contractor
- Jose.Zepeda@brightview.com

Peter Olmedo: Branch Manager

- 14 years in the Green Industry
- BrightView Employee for 9 years
- Sports Turf Manager for 8 years
- Certified Green Industry Best Management Practices
- MOT Certification
- Peter.Olmedo@brightview.com

Kyle R. Krause: Area Director BrightView Golf Southeast Florida

- 12+ year golf course management
- Bachelor of Science - Degree in Turf-Grass Science | The Pennsylvania State University, University Park, PA
- GCSSA Class A Superintendent
- IPM and BMP Certified
- Florida Pesticide License 2018- Current
- Golf Course Superintendents Association of America | 2012 – Present
- Palm Beach Golf Course Superintendents Association | 2019 – Present

DEDICATED ENHANCEMENTS MANAGER



Ramiro Fernandez is the Enhancement Manager for our South Florida Branches. Ramiro has been involved in maintenance and irrigation management throughout the years but his true passion is landscape design, renovation and installation. Mr. Fernandez has been part of the BrightView family for over 13 years and has more than 20 years' experience in the industry.

Ramiro has been running the Enhancement Division for BrightView for over 6 years now and has provided major renovations for partners like St. Regis, Ocean Reef, Mercy Hospital, Trump Grande and Beach Place in Sunny Isles. Outside of work Ramiro spends most of his time with his six children and when he does find a little free time he is working on cars as he 'has a need for speed.

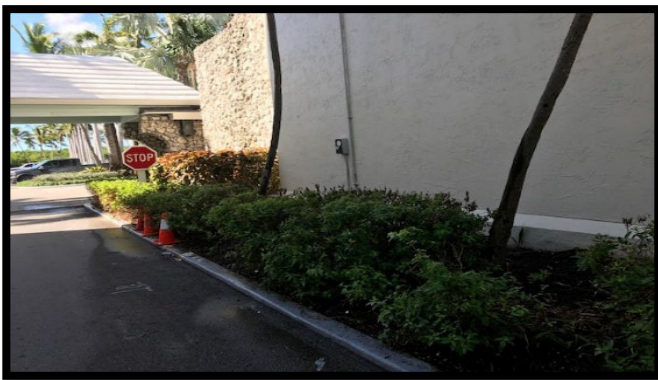

DEDICATED IRRIGATION MANAGER



Carlos Victoria has over 27 years working in the construction / Irrigation industry. As founder of Victoria Construction (1993) and Central Irrigation (2007) has provided him a wide range of experience in the Construction and Irrigation field. With a passion for the irrigation industry, Carlos came on board to ValleyCrest today's (Brightview Landscape Maintenance) in 2009. Today, he serves as the South Florida Regional irrigation Advisor for the company. As an Irrigation contractor/designer, he has developed interest in the water conservation field, becoming a leader using smart irrigation advanced technology for water conservation purposes.

GC NY lic: H-07073

Lawn Sprinkler License Miami FL: 07P000163

Lawn sprinkler License Broward: cc# 08-CLS-14754-R

Backflow Tester License: H-03178

Florida State Plumbing License: CFC1429383

Carlos Victoria has received an engineering degree from CUNY University and currently possess and holds various contracting licenses in the State of FL and NY. Currently he is a Member of the Irrigation Association and other irrigation affiliations.

ISA CERTIFIED ARBORISTS



Name: Corine M. Ferré
Address: 4155 E Mowry Drive
Homestead, FL 33033
Phone: (786) 999-4483
Email: corine.ferre@brightview.com

Ms. Ferré is also a certified instructor at Fairchild Tropical Gardens. She does monthly guided palm and native trail tours at many of our communities.

Certification is available to those who meet predetermined and standardized criteria for knowledge, skills, or competencies. The knowledge needed to pass a Certification assessment is learned through self-study and experience. The assessment is conducted independent of a specific class, course, or other training program. To retain the credential, certificants must meet requirements for renewal.

- ✓ Experience includes both instruction and assessment as part of the program
- ✓ Tests specific knowledge, skills, or competencies associated with learning outcomes
- ✓ Awards a Qualification only to those participants who meet the standards for performance, proficiency, or passing score
- ✓ Allows trainers to know and be familiar with the assessment questions
- ✓ Permits trainers to assess their own trainees, depending on the requirements of a given program
- ✓ Requires credential holders to retrain and retest at the end of a set period of validity, unless qualification is determined to be valid for life



[BrightView Tree Care Services Hollywood](#)
(hyperlink)



BrightView's Got Florida Covered

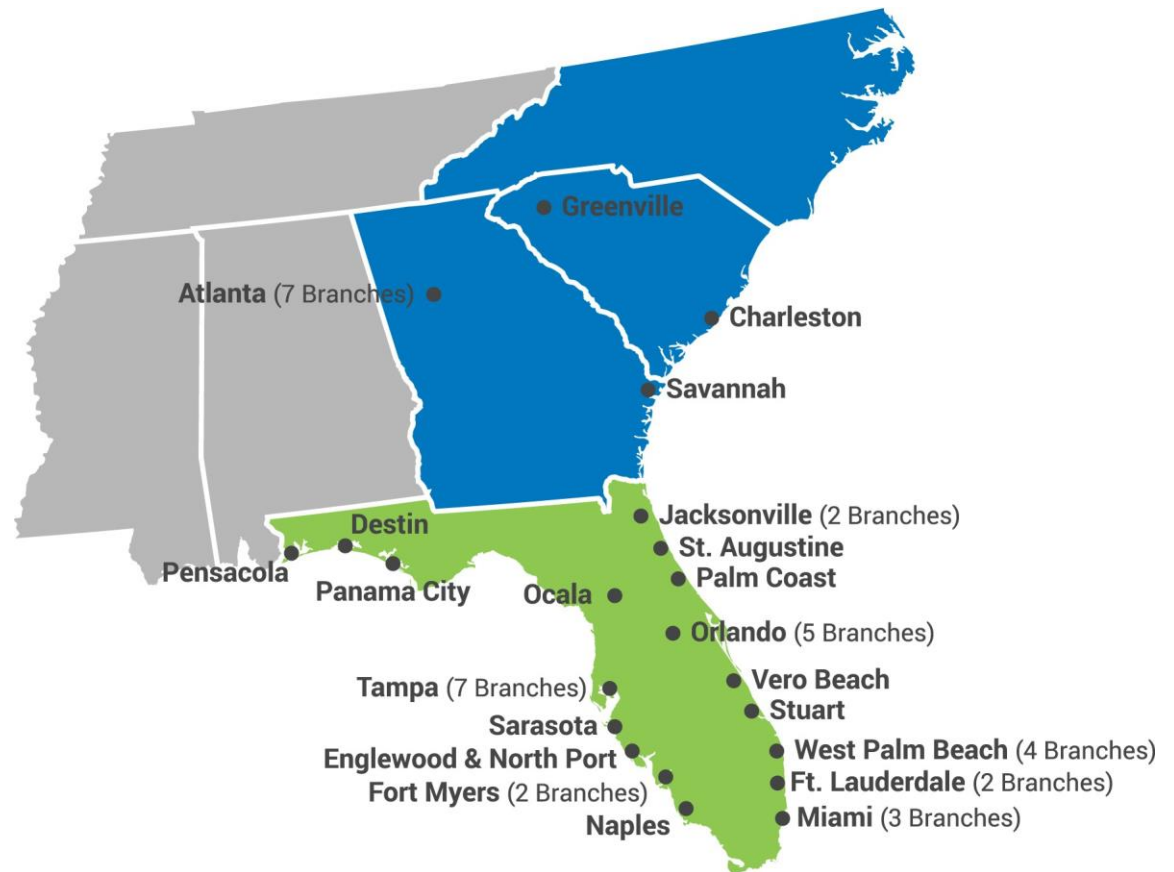

BRIGHTVIEW'S EQUIPMENT



BRIGHTVIEW'S EQUIPMENT



Preserving a Safe Environment



U.S. Citizenship
and Immigration
Services



- To ensure 100% compliance with all labor and immigration laws, we are voluntarily enrolled in E-Verify in all states in which we operate.
- The organization's participation in E-Verify improves our ability to ensure the individuals we hire and who are working on our clients' sites are authorized to work in the United States.
- E-Verify is only part of our robust employment verification program. The program includes a consistent policy and process enterprise-wide, as well as regular training of our staff and semi-annual auditing to maintain compliance with labor and immigration regulations.
- BrightView also participates in the United States Citizenship and Immigration Services (USCIS) H-2B Visa program during seasonal periods when additional workforce is required.

Employment Eligibility Verification
Department of Homeland Security
U.S. Citizenship and Immigration Services

USCIS
Form I-9
OMB No. 1615-0047
Revised 08/12/2019

START HERE: Read instructions carefully before completing this form. The instructions must be available, either in paper or electronically, during completion of this form. Employees are liable for errors in the completion of this form.

ANTI-DISCRIMINATION NOTICE: It is illegal to discriminate against work-authorized individuals. Employers CANNOT specify which document(s) an employee may present to establish employment authorization and identity. The refusal to hire or continue to employ an individual because the documentation presented has a future expiration date may also constitute illegal discrimination.

Section 1. Employee Information and Attestation (Employees must complete and sign Section 1 of Form I-9 no later than the first day of employment, but not before accepting a job offer.)

Last Name (Family Name) First Name (Given Name) Middle Initial Other Last Names Used (If any)
 Address (Street Number and Name) Apt. Number City or Town State ZIP Code
 Date of Birth (mm/dd/yyyy) U.S. Social Security Number Employee's E-mail Address Telephone Number

I am aware that federal law provides for imprisonment and/or fines for false statements and/or false documents in connection with the completion of this form.
 I attest, under penalty of perjury, that I am (check one of the following):

☐ 1. A citizen of the United States
☐ 2. A noncitizen national of the United States (See instructions)
☐ 3. A lawful permanent resident (Alien Registration Number/USCIS I-551)
☐ 4. An alien authorized to work until expiration date, if applicable (Temporary Employment Authorization Document/USCIS I-766)
 Some aliens may write "NA" in the expiration date field. **CAUTION:** Do not write "NA" in the expiration date field if you are an alien authorized to work until expiration date.
 Alien authorized to work must provide any one of the following: (1) Alien Registration Number/USCIS I-551; (2) USCIS I-766; (3) USCIS I-796; (4) USCIS I-797; (5) USCIS I-798; (6) USCIS I-799; (7) USCIS I-799A; (8) USCIS I-799B; (9) USCIS I-799C; (10) USCIS I-799D; (11) USCIS I-799E; (12) USCIS I-799F; (13) USCIS I-799G; (14) USCIS I-799H; (15) USCIS I-799I; (16) USCIS I-799J; (17) USCIS I-799K; (18) USCIS I-799L; (19) USCIS I-799M; (20) USCIS I-799N; (21) USCIS I-799O; (22) USCIS I-799P; (23) USCIS I-799Q; (24) USCIS I-799R; (25) USCIS I-799S; (26) USCIS I-799T; (27) USCIS I-799U; (28) USCIS I-799V; (29) USCIS I-799W; (30) USCIS I-799X; (31) USCIS I-799Y; (32) USCIS I-799Z; (33) USCIS I-799AA; (34) USCIS I-799AB; (35) USCIS I-799AC; (36) USCIS I-799AD; (37) USCIS I-799AE; (38) USCIS I-799AF; (39) USCIS I-799AG; (40) USCIS I-799AH; (41) USCIS I-799AI; (42) USCIS I-799AJ; (43) USCIS I-799AK; (44) USCIS I-799AL; (45) USCIS I-799AM; (46) USCIS I-799AN; (47) USCIS I-799AO; (48) USCIS I-799AP; (49) USCIS I-799AQ; (50) USCIS I-799AR; (51) USCIS I-799AS; (52) USCIS I-799AT; (53) USCIS I-799AU; (54) USCIS I-799AV; (55) USCIS I-799AW; (56) USCIS I-799AX; (57) USCIS I-799AY; (58) USCIS I-799AZ; (59) USCIS I-799BA; (60) USCIS I-799BB; (61) USCIS I-799BC; (62) USCIS I-799BD; (63) USCIS I-799BE; (64) USCIS I-799BF; (65) USCIS I-799BG; (66) USCIS I-799BH; (67) USCIS I-799BI; (68) USCIS I-799BJ; (69) USCIS I-799BK; (70) USCIS I-799BL; (71) USCIS I-799BM; (72) USCIS I-799BN; (73) USCIS I-799BO; (74) USCIS I-799BP; (75) USCIS I-799BQ; (76) USCIS I-799BR; (77) USCIS I-799BS; (78) USCIS I-799BT; (79) USCIS I-799BU; (80) USCIS I-799BV; (81) USCIS I-799BW; (82) USCIS I-799BX; (83) USCIS I-799BY; (84) USCIS I-799BZ; (85) USCIS I-799CA; (86) USCIS I-799CB; (87) USCIS I-799CC; (88) USCIS I-799CD; (89) USCIS I-799CE; (90) USCIS I-799CF; (91) USCIS I-799CG; (92) USCIS I-799CH; (93) USCIS I-799CI; (94) USCIS I-799CJ; (95) USCIS I-799CK; (96) USCIS I-799CL; (97) USCIS I-799CM; (98) USCIS I-799CN; (99) USCIS I-799CO; (100) USCIS I-799CP; (101) USCIS I-799CQ; (102) USCIS I-799CR; (103) USCIS I-799CS; (104) USCIS I-799CT; (105) USCIS I-799CU; (106) USCIS I-799CV; (107) USCIS I-799CW; (108) USCIS I-799CX; (109) USCIS I-799CY; (110) USCIS I-799CZ; (111) USCIS I-799DA; (112) USCIS I-799DB; (113) USCIS I-799DC; (114) USCIS I-799DD; (115) USCIS I-799DE; (116) USCIS I-799DF; (117) USCIS I-799DG; (118) USCIS I-799DH; (119) USCIS I-799DI; (120) USCIS I-799DJ; (121) USCIS I-799DK; (122) USCIS I-799DL; (123) USCIS I-799DM; (124) USCIS I-799DN; (125) USCIS I-799DO; (126) USCIS I-799DP; (127) USCIS I-799DQ; (128) USCIS I-799DR; (129) USCIS I-799DS; (130) USCIS I-799DT; (131) USCIS I-799DU; (132) USCIS I-799DV; (133) USCIS I-799DW; (134) USCIS I-799DX; (135) USCIS I-799DY; (136) USCIS I-799DZ; (137) USCIS I-799EA; (138) USCIS I-799EB; (139) USCIS I-799EC; (140) USCIS I-799ED; (141) USCIS I-799EE; (142) USCIS I-799EF; (143) USCIS I-799EG; (144) USCIS I-799EH; (145) USCIS I-799EI; (146) USCIS I-799EJ; (147) USCIS I-799EK; (148) USCIS I-799EL; (149) USCIS I-799EM; (150) USCIS I-799EN; (151) USCIS I-799EO; (152) USCIS I-799EP; (153) USCIS I-799EQ; (154) USCIS I-799ER; (155) USCIS I-799ES; (156) USCIS I-799ET; (157) USCIS I-799EU; (158) USCIS I-799EV; (159) USCIS I-799EW; (160) USCIS I-799EX; (161) USCIS I-799EY; (162) USCIS I-799EZ; (163) USCIS I-799FA; (164) USCIS I-799FB; (165) USCIS I-799FC; (166) USCIS I-799FD; (167) USCIS I-799FE; (168) USCIS I-799FF; (169) USCIS I-799FG; (170) USCIS I-799FH; (171) USCIS I-799FI; (172) USCIS I-799FJ; (173) USCIS I-799FK; (174) USCIS I-799FL; (175) USCIS I-799FM; (176) USCIS I-799FN; (177) USCIS I-799FO; (178) USCIS I-799FP; (179) USCIS I-799FQ; (180) USCIS I-799FR; (181) USCIS I-799FS; (182) USCIS I-799FT; (183) USCIS I-799FU; (184) USCIS I-799FV; (185) USCIS I-799FW; (186) USCIS I-799FX; (187) USCIS I-799FY; (188) USCIS I-799FZ; (189) USCIS I-799GA; (190) USCIS I-799GB; (191) USCIS I-799GC; (192) USCIS I-799GD; (193) USCIS I-799GE; (194) USCIS I-799GF; (195) USCIS I-799GG; (196) USCIS I-799GH; (197) USCIS I-799GI; (198) USCIS I-799GJ; (199) USCIS I-799GK; (200) USCIS I-799GL; (201) USCIS I-799GM; (202) USCIS I-799GN; (203) USCIS I-799GO; (204) USCIS I-799GP; (205) USCIS I-799GQ; (206) USCIS I-799GR; (207) USCIS I-799GS; (208) USCIS I-799GT; (209) USCIS I-799GU; (210) USCIS I-799GV; (211) USCIS I-799GW; (212) USCIS I-799GX; (213) USCIS I-799GY; (214) USCIS I-799GZ; (215) USCIS I-799HA; (216) USCIS I-799HB; (217) USCIS I-799HC; (218) USCIS I-799HD; (219) USCIS I-799HE; (220) USCIS I-799HF; (221) USCIS I-799HG; (222) USCIS I-799HH; (223) USCIS I-799HI; (224) USCIS I-799HJ; (225) USCIS I-799HK; (226) USCIS I-799HL; (227) USCIS I-799HM; (228) USCIS I-799HN; (229) USCIS I-799HO; (230) USCIS I-799HP; (231) USCIS I-799HQ; (232) USCIS I-799HR; (233) USCIS I-799HS; (234) USCIS I-799HT; (235) USCIS I-799HU; (236) USCIS I-799HV; (237) USCIS I-799HW; (238) USCIS I-799HX; (239) USCIS I-799HY; (240) USCIS I-799HZ; (241) USCIS I-799IA; (242) USCIS I-799IB; (243) USCIS I-799IC; (244) USCIS I-799ID; (245) USCIS I-799IE; (246) USCIS I-799IF; (247) USCIS I-799IG; (248) USCIS I-799IH; (249) USCIS I-799II; (250) USCIS I-799IJ; (251) USCIS I-799IK; (252) USCIS I-799IL; (253) USCIS I-799IM; (254) USCIS I-799IN; (255) USCIS I-799IO; (256) USCIS I-799IP; (257) USCIS I-799IQ; (258) USCIS I-799IR; (259) USCIS I-799IS; (260) USCIS I-799IT; (261) USCIS I-799IU; (262) USCIS I-799IV; (263) USCIS I-799IW; (264) USCIS I-799IX; (265) USCIS I-799IY; (266) USCIS I-799IZ; (267) USCIS I-799JA; (268) USCIS I-799JB; (269) USCIS I-799JC; (270) USCIS I-799JD; (271) USCIS I-799JE; (272) USCIS I-799JF; (273) USCIS I-799JG; (274) USCIS I-799JH; (275) USCIS I-799JI; (276) USCIS I-799JJ; (277) USCIS I-799JK; (278) USCIS I-799JL; (279) USCIS I-799JM; (280) USCIS I-799JN; (281) USCIS I-799JO; (282) USCIS I-799JP; (283) USCIS I-799JQ; (284) USCIS I-799JR; (285) USCIS I-799JS; (286) USCIS I-799JT; (287) USCIS I-799JU; (288) USCIS I-799JV; (289) USCIS I-799JW; (290) USCIS I-799JX; (291) USCIS I-799JY; (292) USCIS I-799JZ; (293) USCIS I-799KA; (294) USCIS I-799KB; (295) USCIS I-799KC; (296) USCIS I-799KD; (297) USCIS I-799KE; (298) USCIS I-799KF; (299) USCIS I-799KG; (300) USCIS I-799KH; (301) USCIS I-799KI; (302) USCIS I-799KJ; (303) USCIS I-799KK; (304) USCIS I-799KL; (305) USCIS I-799KM; (306) USCIS I-799KN; (307) USCIS I-799KO; (308) USCIS I-799KP; (309) USCIS I-799KQ; (310) USCIS I-799KR; (311) USCIS I-799KS; (312) USCIS I-799KT; (313) USCIS I-799KU; (314) USCIS I-799KV; (315) USCIS I-799KW; (316) USCIS I-799KX; (317) USCIS I-799KY; (318) USCIS I-799KZ; (319) USCIS I-799LA; (320) USCIS I-799LB; (321) USCIS I-799LC; (322) USCIS I-799LD; (323) USCIS I-799LE; (324) USCIS I-799LF; (325) USCIS I-799LG; (326) USCIS I-799LH; (327) USCIS I-799LI; (328) USCIS I-799LJ; (329) USCIS I-799LK; (330) USCIS I-799LL; (331) USCIS I-799LM; (332) USCIS I-799LN; (333) USCIS I-799LO; (334) USCIS I-799LP; (335) USCIS I-799LQ; (336) USCIS I-799LR; (337) USCIS I-799LS; (338) USCIS I-799LT; (339) USCIS I-799LU; (340) USCIS I-799LV; (341) USCIS I-799LW; (342) USCIS I-799LX; (343) USCIS I-799LY; (344) USCIS I-799LZ; (345) USCIS I-799MA; (346) USCIS I-799MB; (347) USCIS I-799MC; (348) USCIS I-799MD; (349) USCIS I-799ME; (350) USCIS I-799MF; (351) USCIS I-799MG; (352) USCIS I-799MH; (353) USCIS I-799MI; (354) USCIS I-799MJ; (355) USCIS I-799MK; (356) USCIS I-799ML; (357) USCIS I-799MM; (358) USCIS I-799MN; (359) USCIS I-799MO; (360) USCIS I-799MP; (361) USCIS I-799MQ; (362) USCIS I-799MR; (363) USCIS I-799MS; (364) USCIS I-799MT; (365) USCIS I-799MU; (366) USCIS I-799MV; (367) USCIS I-799MW; (368) USCIS I-799MX; (369) USCIS I-799MY; (370) USCIS I-799MZ; (371) USCIS I-799NA; (372) USCIS I-799NB; (373) USCIS I-799NC; (374) USCIS I-799ND; (375) USCIS I-799NE; (376) USCIS I-799NF; (377) USCIS I-799NG; (378) USCIS I-799NH; (379) USCIS I-799NI; (380) USCIS I-799NJ; (381) USCIS I-799NK; (382) USCIS I-799NL; (383) USCIS I-799NM; (384) USCIS I-799NN; (385) USCIS I-799NO; (386) USCIS I-799NP; (387) USCIS I-799NQ; (388) USCIS I-799NR; (389) USCIS I-799NS; (390) USCIS I-799NT; (391) USCIS I-799NU; (392) USCIS I-799NV; (393) USCIS I-799NW; (394) USCIS I-799NX; (395) USCIS I-799NY; (396) USCIS I-799NZ; (397) USCIS I-799OA; (398) USCIS I-799OB; (399) USCIS I-799OC; (400) USCIS I-799OD; (401) USCIS I-799OE; (402) USCIS I-799OF; (403) USCIS I-799OG; (404) USCIS I-799OH; (405) USCIS I-799OI; (406) USCIS I-799OJ; (407) USCIS I-799OK; (408) USCIS I-799OL; (409) USCIS I-799OM; (410) USCIS I-799ON; (411) USCIS I-799OO; (412) USCIS I-799OP; (413) USCIS I-799OQ; (414) USCIS I-799OR; (415) USCIS I-799OS; (416) USCIS I-799OT; (417) USCIS I-799OU; (418) USCIS I-799OV; (419) USCIS I-799OW; (420) USCIS I-799OX; (421) USCIS I-799OY; (422) USCIS I-799OZ; (423) USCIS I-799PA; (424) USCIS I-799PB; (425) USCIS I-799PC; (426) USCIS I-799PD; (427) USCIS I-799PE; (428) USCIS I-799PF; (429) USCIS I-799PG; (430) USCIS I-799PH; (431) USCIS I-799PI; (432) USCIS I-799PJ; (433) USCIS I-799PK; (434) USCIS I-799PL; (435) USCIS I-799PM; (436) USCIS I-799PN; (437) USCIS I-799PO; (438) USCIS I-799PP; (439) USCIS I-799PQ; (440) USCIS I-799PR; (441) USCIS I-799PS; (442) USCIS I-799PT; (443) USCIS I-799PU; (444) USCIS I-799PV; (445) USCIS I-799PW; (446) USCIS I-799PX; (447) USCIS I-799PY; (448) USCIS I-799PZ; (449) USCIS I-799QA; (450) USCIS I-799QB; (451) USCIS I-799QC; (452) USCIS I-799QD; (453) USCIS I-799QE; (454) USCIS I-799QF; (455) USCIS I-799QG; (456) USCIS I-799QH; (457) USCIS I-799QI; (458) USCIS I-799QJ; (459) USCIS I-799QK; (460) USCIS I-799QL; (461) USCIS I-799QM; (462) USCIS I-799QN; (463) USCIS I-799QO; (464) USCIS I-799QP; (465) USCIS I-799QQ; (466) USCIS I-799QR; (467) USCIS I-799QS; (468) USCIS I-799QT; (469) USCIS I-799QU; (470) USCIS I-799QV; (471) USCIS I-799QW; (472) USCIS I-799QX; (473) USCIS I-799QY; (474) USCIS I-799QZ; (475) USCIS I-799RA; (476) USCIS I-799RB; (477) USCIS I-799RC; (478) USCIS I-799RD; (479) USCIS I-799RE; (480) USCIS I-799RF; (481) USCIS I-799RG; (482) USCIS I-799RH; (483) USCIS I-799RI; (484) USCIS I-799RJ; (485) USCIS I-799RK; (486) USCIS I-799RL; (487) USCIS I-799RM; (488) USCIS I-799RN; (489) USCIS I-799RO; (490) USCIS I-799RP; (491) USCIS I-799RQ; (492) USCIS I-799RR; (493) USCIS I-799RS; (494) USCIS I-799RT; (495) USCIS I-799RU; (496) USCIS I-799RV; (497) USCIS I-799RW; (498) USCIS I-799RX; (499) USCIS I-799RY; (500) USCIS I-799RZ; (501) USCIS I-799SA; (502) USCIS I-799SB; (503) USCIS I-799SC; (504) USCIS I-799SD; (505) USCIS I-799SE; (506) USCIS I-799SF; (507) USCIS I-799SG; (508) USCIS I-799SH; (509) USCIS I-799SI; (510) USCIS I-799SJ; (511) USCIS I-799SK; (512) USCIS I-799SL; (513) USCIS I-799SM; (514) USCIS I-799SN; (515) USCIS I-799SO; (516) USCIS I-799SP; (517) USCIS I-799SQ; (518) USCIS I-799SR; (519) USCIS I-799SS; (520) USCIS I-799ST; (521) USCIS I-799SU; (522) USCIS I-799SV; (523) USCIS I-799SW; (524) USCIS I-799SX; (525) USCIS I-799SY; (526) USCIS I-799SZ; (527) USCIS I-799TA; (528) USCIS I-799TB; (529) USCIS I-799TC; (530) USCIS I-799TD; (531) USCIS I-799TE; (532) USCIS I-799TF; (533) USCIS I-799TG; (534) USCIS I-799TH; (535) USCIS I-799TI; (536) USCIS I-799TJ; (537) USCIS I-799TK; (538) USCIS I-799TL; (539) USCIS I-799TM; (540) USCIS I-799TN; (541) USCIS I-799TO; (542) USCIS I-799TP; (543) USCIS I-799TQ; (544) USCIS I-799TR; (545) USCIS I-799TS; (546) USCIS I-799TT; (547) USCIS I-799TU; (548) USCIS I-799TV; (549) USCIS I-799TW; (550) USCIS I-799TX; (551) USCIS I-799TY; (552) USCIS I-799TZ; (553) USCIS I-799UA; (554) USCIS I-799UB; (555) USCIS I-799UC; (556) USCIS I-799UD; (557) USCIS I-799UE; (558) USCIS I-799UF; (559) USCIS I-799UG; (560) USCIS I-799UH; (561) USCIS I-799UI; (562) USCIS I-799UJ; (563) USCIS I-799UK; (564) USCIS I-799UL; (565) USCIS I-799UM; (566) USCIS I-799UN; (567) USCIS I-799UO; (568) USCIS I-799UP; (569) USCIS I-799UQ; (570) USCIS I-799UR; (571) USCIS I-799US; (572) USCIS I-799UT; (573) USCIS I-799UU; (574) USCIS I-799UV; (575) USCIS I-799UW; (576) USCIS I-799UX; (577) USCIS I-799UY; (578) USCIS I-799UZ; (579) USCIS I-799VA; (580) USCIS I-799VB; (581) USCIS I-799VC; (582) USCIS I-799VD; (583) USCIS I-799VE; (584) USCIS I-799VF; (585) USCIS I-799VG; (586) USCIS I-799VH; (587) USCIS I-799VI; (588) USCIS I-799VJ; (589) USCIS I-799VK; (590) USCIS I-799VL; (591) USCIS I-799VM; (592) USCIS I-799VN; (593) USCIS I-799VO; (594) USCIS I-799VP; (595) USCIS I-799VQ; (596) USCIS I-799VR; (597) USCIS I-799VS; (598) USCIS I-799VT; (599) USCIS I-799VU; (600) USCIS I-799VV; (601) USCIS I-799VW; (602) USCIS I-799VX; (603) USCIS I-799VY; (604) USCIS I-799VZ; (605) USCIS I-799WA; (606) USCIS I-799WB; (607) USCIS I-799WC; (608) USCIS I-799WD; (609) USCIS I-799WE; (610) USCIS I-799WF; (611) USCIS I-799WG; (612) USCIS I-799WH; (613) USCIS I-799WI; (614) USCIS I-799WJ; (615) USCIS I-799WK; (616) USCIS I-799WL; (617) USCIS I-799WM; (618) USCIS I-799WN; (619) USCIS I-799WO; (620) USCIS I-799WP; (621) USCIS I-799WQ; (622) USCIS I-799WR; (623) USCIS I-799WS; (624) USCIS I-799WT; (625) USCIS I-799WU; (626) USCIS I-799WV; (627) USCIS I-799WW; (628) USCIS I-799WX; (629) USCIS I-799WY; (630) USCIS I-799WZ; (631) USCIS I-799XA; (632) USCIS I-799XB; (633) USCIS I-799XC; (634) USCIS I-799XD; (635) USCIS I-799XE; (636) USCIS I-799XF; (637) USCIS I-799XG; (638) USCIS I-799XH; (639) USCIS I-799XI; (640) USCIS I-799XJ; (641) USCIS I-799XK; (642) USCIS I-799XL; (643) USCIS I-799XM; (644) USCIS I-799XN; (645) USCIS I-799XO; (646) USCIS I-799XP; (647) USCIS I-799XQ; (648) USCIS I-799XR; (649) USCIS I-799XS; (650) USCIS I-799XT; (651) USCIS I-799XU; (652) USCIS I-799XV; (653) USCIS I-799XW; (654) USCIS I-799XX; (655) USCIS I-799XY; (656) USCIS I-799XZ; (657) USCIS I-799YA; (658) USCIS I-799YB; (659) USCIS I-799YC; (660) USCIS I-799YD; (661) USCIS I-799YE; (662) USCIS I-799YF; (663) USCIS I-799YG; (664) USCIS I-799YH; (665) USCIS I-799YI; (666) USCIS I-799YJ; (667) USCIS I-799YK; (668) USCIS I-799YL; (669) USCIS I-799YM; (670) USCIS I-799YN; (671) USCIS I-799YO; (672) USCIS I-799YP; (673) USCIS I-799YQ; (674) USCIS I-799YR; (675) USCIS I-799YS; (676) USCIS I-799YT; (677) USCIS I-799YU; (678) USCIS I-799YV; (679) USCIS I-799YW; (680) USCIS I-799YX; (681) USCIS I-799YY; (682) USCIS I-799YZ; (683) USCIS I-799ZA; (684) USCIS I-799ZB; (685) USCIS I-799ZC; (686) USCIS I-799ZD; (687) USCIS I-799ZE; (688) USCIS I-799ZF; (689) USCIS I-799ZG; (690) USCIS I-799ZH; (691) USCIS I-799ZI; (692) USCIS I-799ZJ; (693) USCIS I-799ZK; (694) USCIS I-799ZL; (695) USCIS I-799ZM; (696) USCIS I-799ZN; (697) USCIS I-799ZO; (698) USCIS I-799ZP; (699) USCIS I-799ZQ; (700) USCIS I-799ZR; (701) USCIS I-799ZS; (702) USCIS I-799ZT; (703) USCIS I-799ZU; (704) USCIS I-799ZV; (705) USCIS I-799ZW; (706) USCIS I-799ZX; (707) USCIS I-799ZY; (708) USCIS I-799ZZ; (709) USCIS I-799AAA; (710) USCIS I-799AAB; (711) USCIS I-799AAC; (712) USCIS I-799AAD; (713) USCIS I-799AAE; (714) USCIS I-799AAF; (715) USCIS I-799AAG; (716) USCIS I-799AAH; (717) USCIS I-799AAI; (718) USCIS I-799AAJ; (719) USCIS I-799AAK; (720) USCIS I-799AAL; (721) USCIS I-799AAM; (722) USCIS I-799AAN; (723) USCIS I-799AAO; (724) USCIS I-799AAP; (725) USCIS I-799AAQ; (726) USCIS I-799AAR; (727) USCIS I-799AAS; (728) USCIS I-799AAT; (729) USCIS I-799AAU; (730) USCIS I-799AAV; (731) USCIS I-799AAW; (732) USCIS I-799AAX; (733) USCIS I-799AAZ; (734) USCIS I-799AAB; (735) USCIS I-799AAC; (736) USCIS I-799AAD; (737) USCIS I-799AAE; (738) USCIS I-799AAF; (739) USCIS I-799AAG; (740) USCIS I-799AAH; (741) USCIS I-799AAI; (742) USCIS I-799AAJ; (743) USCIS I-799AAK; (744) USCIS I-799AAL; (745) USCIS I-799AAM; (746) USCIS I-799AAN; (747) USCIS I-799AAO; (748) USCIS I-799AAP; (749) USCIS I-799AAQ; (750) USCIS I-799AAR; (751) USCIS I-799AAS; (752) USCIS I-799AAT; (753) USCIS I-799AAU; (754) USCIS I-799AAV; (755) USCIS I-799AAW; (756) USCIS I-799AAX; (757) USCIS I-799AAZ; (758) USCIS I-799AAB; (759) USCIS I-799AAC; (760) USCIS I-799AAD; (761) USCIS I-799AAE; (762) USCIS I-799AAF; (763) USCIS I-799AAG; (764) USCIS I-799AAH; (765) USCIS I-799AAI; (766) USCIS I-799AAJ; (767) USCIS I-799AAK; (768) USCIS I-799AAL; (769) USCIS I-799AAM; (770) USCIS I-799AAN; (771) USCIS I-799AAO; (772) USCIS I-799AAP; (773) USCIS I-799AAQ; (774) USCIS I-799AAR; (775) USCIS I-799AAS; (776) USCIS I-799AAT; (777) USCIS I-799AAU; (778) USCIS I-799AAV; (779) USCIS I-799AAW; (780) USCIS I-799AAX; (781) USCIS I-799AAZ; (782) USCIS I-799AAB; (783) USCIS I-799AAC; (784) USCIS I-799AAD; (785) USCIS I-799AAE; (786) USCIS I-799AAF; (787) USCIS I-799AAG; (788) USCIS I-799AAH; (789) USCIS I-799AAI; (790) USCIS I-799AAJ; (791) USCIS I-799AAK; (792) USCIS I-799AAL; (793) USCIS I-799AAM; (794) USCIS I-799AAN; (795) USCIS I-799AAO; (796) USCIS I-799AAP; (797) USCIS I-799AAQ; (798) USCIS I-799AAR; (799) USCIS I-799AAS; (800) USCIS I-799AAT; (801) USCIS I-799AAU; (802) USCIS I-799AAV; (803) USCIS I-799AAW; (804) USCIS I-799A

BrightView Resources

Delivering Added Value to Your Community

Quality Site Assessment

Prepared for: Liberty Bay HOA

General Information

DATE: Tuesday, Nov 21, 2023
NEXT QSA DATE: Monday, Feb 19, 2024
CLIENT ATTENDEES: Amanda Foster
BRIGHTVIEW ATTENDEES: Jose Zepeda

Customer Focus Areas

Maintenance items

Quality you can count on.

7 Seven Standards of Excellence



Site Cleanliness



Weed Free



Green Turf



Crisp Edges

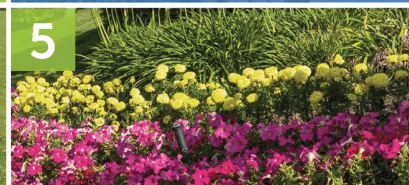

Spectacular Flowers



Uniformly Mulched Beds

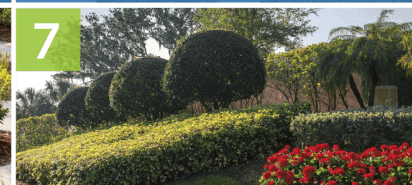

Neatly Pruned Trees & Shrubs

QUALITY SITE ASSESSMENT

Liberty Bay HOA

Maintenance Items



1 Grass has been mowed in advance of the holidays

2 Property has been trimmed and weed control on beds completed

3 Damaged grass was fixed for second time

4 Property is fully detailed and weed free

QUALITY SITE ASSESSMENT

Liberty Bay HOA

Completed Items



1 Bushes in common area trimmed and beds treated for weeds

2 Example of concrete edged and grass mowed

3 Example of trimmed bushes and mowed lawn

4 Some weeds under hedges will need to be treated again. We will monitor and apply as needed

Introducing the All New BrightView Connect



Stay connected with your landscape services — anytime, anywhere. With the new BrightView Connect, managing your landscape services has never been easier. This secure online portal is private to you, with a host of convenient features available on demand. **See what BrightView Connect can do for you:**



Submit Service Requests

Effortlessly request service and upload photos of affected areas for reference

Receive Service Confirmations

Know when services are completed, via a cadence and method that works best for you



View Your Enhancement Proposals

BrightView Connect keeps the proposals in your account and at your fingertips

View Your Standard Maintenance Schedule

Know the dates we plan to be on your property



View Quality Site Assessments

A historical account of our performance on your property available for easy reference any time

Communication Your Way

Voluntary participation means no matter how you choose to connect we'll always be responsive



Go to connect.brightview.com to get started or ask your Account Manager for assistance.

*Some features may not be available at all properties.
Check with your Account Manager for more details.*



DESIGN CAPABILITIES

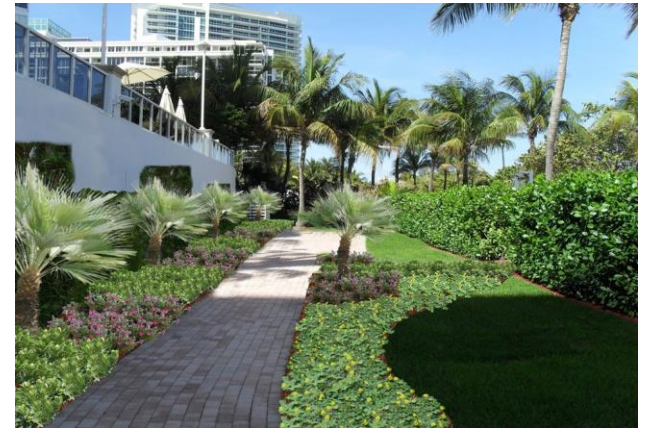
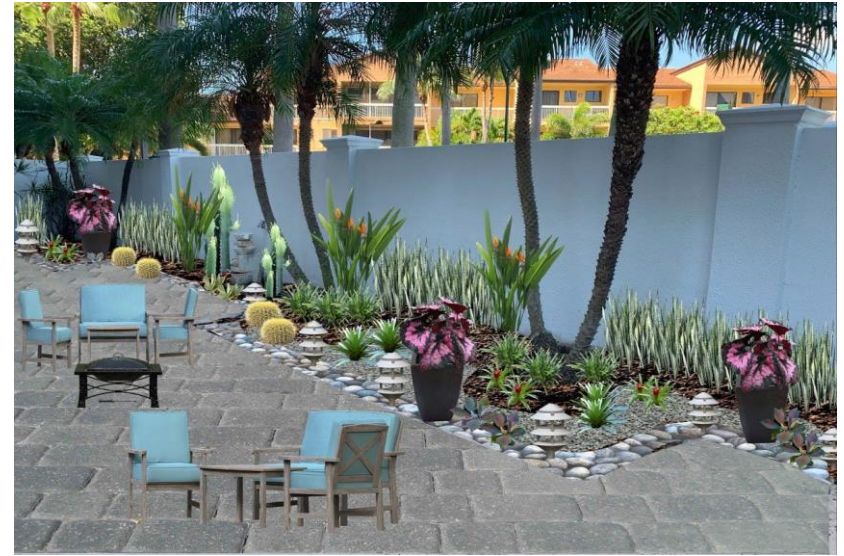

EMERGENCY RESPONSE

When a catastrophe occurs such most recently with Hurricane Irma, we have the capabilities and manpower to respond immediately. With 47 locations throughout the Southeast alone, [we leverage our local and national resources](#) to bring in additional teams and equipment from outside the area. This allows us to ensure the site is safe and free from hazards.

Resources from branch offices will be available in the event of an emergency to ensure [our customers have access to crews and equipment quickly](#). We partner with generator-powered area hotels to provide accommodations for our staff. We have no FEMA obligations that would impact our ability to clean up your site in a prompt manner.

Safety *before and after* a storm is our primary focus. Immediately following the storm, our teams will ensure:

- Vehicle access is cleared, allowing emergency personnel access.
- Debris from structural dwellings that may pose immediate risk is cleared.
- Plant material that may have a chance of surviving is replanted.
- Hazardous damaged limbs that remain in trees are trimmed and removed.
- Tree limbs, root balls, or large wood debris remaining on the ground is chipped and removed.
- Final restoration of any remaining damages or losses resulting from the storm is performed.

Our benchmark is to have your property back to normal within one week of the all-clear.

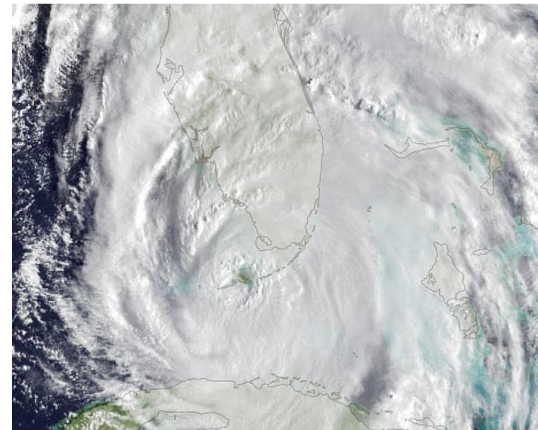

Let us Help you Weather the Storm.



Hurricane season is upon us again. No matter what Mother Nature may bring, your BrightView team is looking out for you. To ensure we're able to provide you with a swift and seamless response following severe weather, we recommend the following: ▼

► Pre-Authorize Post-Storm Clean Up

Pre-authorization of hurricane clean-up services allows us to immediately begin work post-storm, getting you back to business-as-usual as soon as possible. Learn more below about the action plan we mobilize on your behalf, and indicate your authorization with a signature on the next page.

► Keep us Apprised of your Insurance Requirements

Let us know any special needs or requirements your insurance carrier may have for documenting damages or corrective actions resulting from a storm. Our team will help make your job easier by photographing representative damage and journaling manpower, equipment and the work provided in our repairs.

► Let us Know How to Reach You

Previous years' storms have shown us how vulnerable communications can be during and after severe weather. Update your contact information on the following page so we can keep you apprised during emergency response situations.

► Prepare your Trees

Most maintenance contracts cover tree pruning to provide traffic clearance, but this doesn't prepare trees for hurricanes or excessive wind. Dramatically reduce the risk of damage and injury by structurally pruning weak or dead branches and opening canopies to reduce resistance. Schedule an assessment with our certified arborists to ensure your trees are ready.

Have Peace Of Mind With Pre-Authorized Storm Clean-Up.

Your BrightView team has an action plan that proactively addresses your needs in an emergency situation. With pre-authorized clean-up, we're on the ground canvassing your property to assess damage as soon as the storm has passed, and quickly dispatch the appropriate landscape and tree care services teams to address your needs, prioritizing safety first:

- Vehicle access is cleared, allowing emergency personnel access.
- Debris from structural dwellings that may pose immediate risk is cleared.
- Plant material that may have a chance of surviving is replanted.
- Hazardous damaged limbs that remain in trees are trimmed and removed.
- Tree limbs, rootballs, or large wood debris remaining on the ground is chipped and removed.
- Final restoration of any remaining damages or losses resulting from the storm is performed.

To expedite clean-up efforts, we leverage our national resources to bring in additional teams from outside the area. Normal maintenance operations can typically resume the following week for all but the most severely debris-impacted properties. If you would like to pre-approve BrightView to perform clean-up operations as detailed above, sign where indicated. Our emergency rates are also listed for your review. Dump expenses range based on the material, size and weight.

Contact Us

Approval for clean-up services:

Sign	Property Name
------	---------------

Print Name/Title	Date
------------------	------

Emergency contact numbers:

Name	Phone
------	-------

Name	Phone
------	-------

Hurricane Price List

Labor	\$60/hour
Operator	\$75/hour
Driver	\$75/hour
340/44 S454 Tractor Loaders	\$150/hour
New Holland - Solid Steer Loader	\$150/hour
Backhoe	\$150/hour
Delivery/Pickup All Tractors except 444	\$450
Delivery/Pickup 444	\$500
Flatbed Truck	\$75/hour
Water Truck	\$175/hour
Irrigation Work/Tech	\$75
Irrigation Work/Helper	\$50
Tree Trimming/Per Day/3 Man Crew	\$3600
Crane Rental/60 Ton	\$260/hour (4 hour minimum)
Stump Grinder/Per Hour + Operator	\$225/hour

QUALITY WORKMANSHIP



QUALITY WORKMANSHIP



QUALITY WORKMANSHIP



LICENSES & CERTIFICATIONS

- ATSSA Certified - Temporary Traffic Control Supervisor
- American Red Cross AED/CPR/ First Aid
- American Red Cross AED/CPR/ First Aid Instructor
- OSHA 10 Card - Construction Safety and Health
- FL Pesticide Applicator Certificate - Registered Tech
- VCLM - Excavation Safety - Competent Person Training
- VCLM - Forklift Safety - Trainer
- VCLM Fall Protection Training
- VCLM Fall Protection - Competent Person /Trainer
- Pesticide Applicator Certificate for Lawn and Ornamental
- ISA Certified Arborist
- FL Licensed Tree Expert
- ISA Certified Arborist
- Certified Tree Risk Assessor
- Florida Certified Horticulturist
- Florida Certified Pesticide Applicator
- Certified Irrigation Contractor and Certified Landscape Irrigation Auditor by the Irrigation Association which is a national certifying body for the irrigation industry.
- Average of 30 years of experience in the green industry
- Degreed horticulturalist
- Masters of Business Administration



**American
Red Cross**
Training Services

STATE OF FLORIDA DEPARTMENT OF TRANSPORTATION



**Temporary Traffic Control
(Maintenance of Traffic)
Training Handbook**

OFFICE OF DESIGN - ROADWAY STANDARDS SECTION
JANUARY 2016
TALLAHASSEE, FLORIDA



FEMA



**NATIONAL
ASSOCIATION OF
LANDSCAPE
PROFESSIONALS**



Request for Taxpayer Identification Number and Certification

► Go to www.irs.gov/FormW9 for instructions and the latest information.

Give Form to the
requester. Do not
send to the IRS.

Print or type.
See Specific Instructions on page 3.

1 Name (as shown on your income tax return). Name is required on this line; do not leave this line blank.

BrightView Landscape Services, Inc.

2 Business name/disregarded entity name, if different from above

3 Check appropriate box for federal tax classification of the person whose name is entered on line 1. Check only **one** of the following seven boxes.

☐ Individual/sole proprietor or single-member LLC ☒ C Corporation ☐ S Corporation ☐ Partnership ☐ Trust/estate

☐ Limited liability company. Enter the tax classification (C=C corporation, S=S corporation, P=Partnership) ►

Note: Check the appropriate box in the line above for the tax classification of the single-member owner. Do not check LLC if the LLC is classified as a single-member LLC that is disregarded from the owner unless the owner of the LLC is another LLC that is **not** disregarded from the owner for U.S. federal tax purposes. Otherwise, a single-member LLC that is disregarded from the owner should check the appropriate box for the tax classification of its owner.

☐ Other (see instructions) ►

4 Exemptions (codes apply only to certain entities, not individuals; see instructions on page 3):

Exempt payee code (if any) _____

Exemption from FATCA reporting code (if any) **5**

(Applies to accounts maintained outside the U.S.)

5 Address (number, street, and apt. or suite no.) See instructions.

P.O. Box 740655

6 City, state, and ZIP code

Atlanta, GA 30374-0655

7 List account number(s) here (optional)

Requester's name and address (optional)

Part I Taxpayer Identification Number (TIN)

Enter your TIN in the appropriate box. The TIN provided must match the name given on line 1 to avoid backup withholding. For individuals, this is generally your social security number (SSN). However, for a resident alien, sole proprietor, or disregarded entity, see the instructions for Part I, later. For other entities, it is your employer identification number (EIN). If you do not have a number, see *How to get a TIN*, later.

Note: If the account is in more than one name, see the instructions for line 1. Also see *What Name and Number To Give the Requester* for guidelines on whose number to enter.

Social security number

____ - ____ - ____

or

Employer identification number

9 5 - 4 1 9 4 2 2 3

Part II Certification

Under penalties of perjury, I certify that:

1. The number shown on this form is my correct taxpayer identification number (or I am waiting for a number to be issued to me); and
2. I am not subject to backup withholding because: (a) I am exempt from backup withholding, or (b) I have not been notified by the Internal Revenue Service (IRS) that I am subject to backup withholding as a result of a failure to report all interest or dividends, or (c) the IRS has notified me that I am no longer subject to backup withholding; and
3. I am a U.S. citizen or other U.S. person (defined below); and
4. The FATCA code(s) entered on this form (if any) indicating that I am exempt from FATCA reporting is correct.

Certification instructions. You must cross out item 2 above if you have been notified by the IRS that you are currently subject to backup withholding because you have failed to report all interest and dividends on your tax return. For real estate transactions, item 2 does not apply. For mortgage interest paid, acquisition or abandonment of secured property, cancellation of debt, contributions to an individual retirement arrangement (IRA), and generally, payments other than interest and dividends, you are not required to sign the certification, but you must provide your correct TIN. See the instructions for Part II, later.

Sign
Here

Signature of
U.S. person ►

T. Brown

Date ►

11/10/23

General Instructions

Section references are to the Internal Revenue Code unless otherwise noted.

Future developments. For the latest information about developments related to Form W-9 and its instructions, such as legislation enacted after they were published, go to www.irs.gov/FormW9.

Purpose of Form

An individual or entity (Form W-9 requester) who is required to file an information return with the IRS must obtain your correct taxpayer identification number (TIN) which may be your social security number (SSN), individual taxpayer identification number (ITIN), adoption taxpayer identification number (ATIN), or employer identification number (EIN), to report on an information return the amount paid to you, or other amount reportable on an information return. Examples of information returns include, but are not limited to, the following.

- Form 1099-INT (interest earned or paid)

- Form 1099-DIV (dividends, including those from stocks or mutual funds)
- Form 1099-MISC (various types of income, prizes, awards, or gross proceeds)
- Form 1099-B (stock or mutual fund sales and certain other transactions by brokers)
- Form 1099-S (proceeds from real estate transactions)
- Form 1099-K (merchant card and third party network transactions)
- Form 1098 (home mortgage interest), 1098-E (student loan interest), 1098-T (tuition)
- Form 1099-C (canceled debt)
- Form 1099-A (acquisition or abandonment of secured property)

Use Form W-9 only if you are a U.S. person (including a resident alien), to provide your correct TIN.

If you do not return Form W-9 to the requester with a TIN, you might be subject to backup withholding. See What is backup withholding, later.



ANNE M. GANNON
CONSTITUTIONAL TAX COLLECTOR
Serving Palm Beach County
Serving you.

P.O. Box 3353, West Palm Beach, FL 33402-3353
www.pbctax.com Tel: (561) 355-2264

****LOCATED AT****
13710 OKEECHOBEE BLVD
LOXAHATCHEE FL 33470

TYPE OF BUSINESS	OWNER	CERTIFICATION #	RECEIPT #/DATE PAID	AMT PAID	BILL #
LANDSCAPING	BRIGHTVIEW LANDSCAPE SERVICES INC		B23.736595 9/20/2023	236.25	B40139136

This document is valid only when receipted by the Tax Collector's Office.

BRIGHTVIEW LANDSCAPE SERVICES INC
BRIGHTVIEW LANDSCAPE SERVICES INC
980 JOLLY RD STE 300
BLUE BELL PA 19422

STATE OF FLORIDA
PALM BEACH COUNTY
2023 / 2024 LOCAL BUSINESS TAX RECEIPT
LBTR Number: 201364290
EXPIRES: 9/30/2024

This receipt grants the privilege of engaging in or managing any business profession or occupation within its jurisdiction and MUST be conspicuously displayed at the place of business and in such a manner as to be open to the view of the public.

Thank You for Your Consideration!

